

8K 2x2 HDMI™ Switcher with Dual Outputs

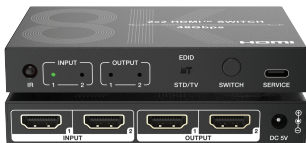

User Manual

VER 1.0

Thank you for purchasing this product

For optimum performance and safety, please read these instructions carefully before connecting, operating or adjusting this product. Please keep this manual for future reference.

Surge protection device recommended

This product contains sensitive electrical components that may be damaged by electrical spikes, surges, electric shock, lightning strikes, etc. Use of surge protection systems is highly recommended in order to protect and extend the life of your equipment.

Table of Contents

1. Introduction.....	1
2. Features.....	1
3. Package Contents.....	2
4. Specifications.....	2
5. Operation Controls and Functions.....	4
6. IR Remote.....	5
7. Application Example.....	6

1. Introduction

The 8K 2x2 HDMI™ Switcher is designed with two inputs and two outputs, can distribute any of the two HDMI™ input signals to two displays simultaneously and quickly, with various video resolutions such as 8K@60Hz and 4K@120Hz, and 48Gbps video bandwidth. It supports auto switching and manual switching.

The product has two EDID modes: STD and TV. IR and CEC control are supported.

It can be widely used in multimedia conference halls, television teaching, large-screen display and other applications.

2. Features

- ☆ HDCP 2.3 compliant
- ☆ Various video resolution up to 8K@60Hz 4:2:0 12bit, 8K@30Hz 4:4:4 12bit, 4K@120Hz 4:4:4 12bit, and 48Gbps bandwidth
- ☆ 2x2 switcher with dual outputs
- ☆ HDR, HDR10, HDR10+, Dolby Vision, HLG pass-through
- ☆ HDMI™ audio formats: LPCM, Dolby Digital/Plus/EX, Dolby True HD, DTS, DTS-EX, DTS-96/24, DTS High Res, DTS-HD Master Audio, DSD
- ☆ Two EDID modes: STD and TV
- ☆ Control via front panel button and IR remote
- ☆ Support auto switching and manual switching
- ☆ With resolution downscaling: 8K->4K, 8K/4K->1080p
- ☆ CEC is supported on HDMI™ OUTPUT 1
- ☆ Compact design for easy and flexible installation

3. Package Contents

- ① 1× 8K 2x2 HDMI™ Switcher
- ② 1× IR Remote
- ③ 1× 5V/2A Power Supply
- ④ 1× User Manual

4. Specifications

Technical	
HDMI™ Compliance	HDMI™ 2.1
HDCP Compliance	HDCP 2.3
Video Bandwidth	48Gbps
Video Resolution	Up to 8K@60Hz 4:2:0 12bit, 8K@30Hz 4:4:4 12bit, 4K@120Hz 4:4:4 12bit * All available resolutions are shown as follow.
Color Depth	8-bit,10-bit,12-bit
Color Space	RGB, YCbCr_4:4:4, YCbCr_4:2:2, YCbCr_4:2:0
HDMI™ Audio Formats	LPCM, Dolby Digital/Plus/EX, Dolby True HD, DTS, DTS-EX, DTS-96/24, DTS High Res, DTS-HD Master Audio, DSD
HDR	HDR, HDR10, HDR10+, Dolby Vision, HLG
ESD Protection	IEC 61000-4-2: ±8kV (Air-gap discharge), ±4kV (Contact discharge)
Connection	
Input	2× INPUT [HDMI™ Type A, 19-pin female]
Output	2× OUTPUT [HDMI™ Type A, 19-pin female]
Control	1× SERVICE [USB Type C, FW update port]
Mechanical	
Housing	Metal
Color	Black
Dimensions	110mm (W) × 75mm (D) × 18mm (H)
Weight	220g

Power Supply	Input: AC 100~240V 50/60Hz, Output: DC 5V/2A (US/EU standards, CE/FCC/UL certified)		
Power Consumption	5.2W (Max)		
Operation Temperature	0°C ~ 40°C / 32°F ~ 104°F		
Storage Temperature	-20°C ~ 60°C / -4°F ~ 140°F		
Operating Humidity	20%~80% relative humidity, non-condensing		
Storage Humidity	10%~90% relative humidity, non-condensing		
Recommended HDMI™ Cable			
Video Resolution	8K	4K60	1080P
HDMI™ Cable Length (IN / OUT)	3m/10ft (Ultra HDMI™ 2.1)	8m/26ft	20m/66ft
The use of "Premium High Speed HDMI™" cable is highly recommended.			

* All available input/output resolutions:

640x480p60Hz, 800x600p60Hz, 1024x768p60Hz, 1280x1024p60Hz, 1360x768p60Hz, 1440x900p60Hz, 1440x1050p60Hz, 1600x1200p60Hz, 720x480i59.94Hz(480i59), 720x480p59.94Hz(480p59), 720x576i50Hz(576i50), 720x576p50Hz(576p50), 1280x720p50Hz(720p50), 1280x720p59.94Hz(720p59), 1280x720p60Hz(720p60), 1920x1080i50Hz(1080i50), 1920x1080i59.94Hz(1080i59), 1920x1080i60Hz(1080i60), 1920x1080p23.98Hz(1080p23), 1920x1080p24Hz(1080p24), 1920x1080p25Hz(1080p25), 1920x1080p29.97Hz(1080p29), 1920x1080p30Hz(1080p30), 1920x1080p50Hz(1080p50), 1920x1080p59.94Hz(1080p59), 1920x1080p60Hz(1080p60), 3840x2160p23.98Hz(2160p23), 3840x2160p24Hz(2160p24), 3840x2160p25Hz(2160p25), 3840x2160p29.97Hz(2160p29), 3840x2160p30Hz(2160p30), 3840x2160p50Hz(2160p50), 3840x2160p59.94Hz(2160p59), 3840x2160p60Hz(2160p60), 3840x2160p100Hz(2160p100), 3840x2160p120Hz(2160p120), 4096x2160p23.98Hz, 4096x2160p24Hz, 4096x2160p25Hz, 4096x2160p29.97Hz, 4096x2160p30Hz, 4096x2160p50Hz, 4096x2160p59.94Hz, 4096x2160p60Hz, 4096x2160p100Hz, 4096x2160p120Hz, 5120x2160p50Hz, 5120x2160p60Hz, 7680x4320p23.98Hz, 7680x4320p24Hz, 7680x4320p25Hz, 7680x4320p29.97Hz, 7680x4320p30Hz, 7680x4320p50Hz, 7680x4320p60Hz

5. Operation Controls and Functions

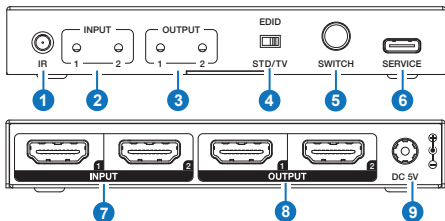

No.	Name	Function Description
1	IR window	IR signal receiving window.
2	INPUT 1/2 LED	When the INPUT 1/2 is selected as the signal input channel, the corresponding green LED will be on.
3	OUTPUT 1/2 LED	When the OUTPUT 1/2 is selected as the output channel, the corresponding green LED will be on.
4	EDID dial switch	STD: All OUTPUT ports output 4K@60Hz video by default. TV: Copy EDID from OUTPUT ports to source device, and then the source device will send a signal matching with the display devices to output ports. OUTPUT 1 is copied by default. If no device is detected on OUTPUT 1 port then OUTPUT 2 will be copied.
5	SWITCH	<ul style="list-style-type: none"> Short press to select the input source manually. Long press for 3 seconds to enable or disable the auto switching function.
6	SERVICE	Used for firmware update.
7	HDMI INPUT 1/2	HDMI signal input ports, connected to source devices such as DVD or set-top box with HDMI cable.
8	HDMI OUTPUT 1/2	HDMI signal output ports, connected to display devices such as TV or Monitor with HDMI cable.
9	DC 5V	DC 5V/2A power input port.

Auto Switching:

The auto switching function can be enabled or disabled via the SWITCH button on the front panel. It is enabled by default.

1. If one INPUT port is connected, and the other is connected later. It will switch to the latest one automatically (last in gets priority) as the input channel, and the corresponding LED will be on.
2. If the two INPUT ports are all connected, when one of them is disconnected, it will switch to the next INPUT port automatically.
3. If only one INPUT port is connected, it will not automatically switch to the other when disconnected.

6. IR Remote



Power on the product or set it to standby mode.

1/2 :

Press 1/2 button to select HDMI signal source INPUT 1/2 to the OUTPUT port.



Press this button to cyclically switch HDMI signal source INPUT 1/2.

7. Application Example

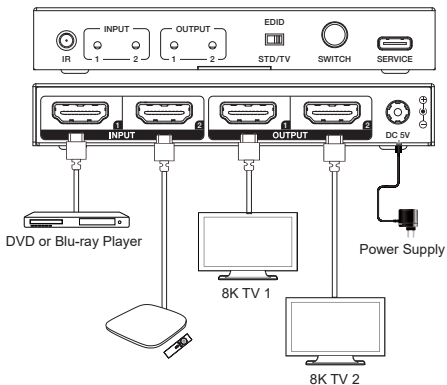

HDMI™
HIGH-DEFINITION MULTIMEDIA INTERFACE

The terms HDMI, HDMI High-Definition Multimedia Interface, HDMI trade dress and the HDMI Logos are trademarks or registered trademarks of HDMI Licensing Administrator, Inc.