

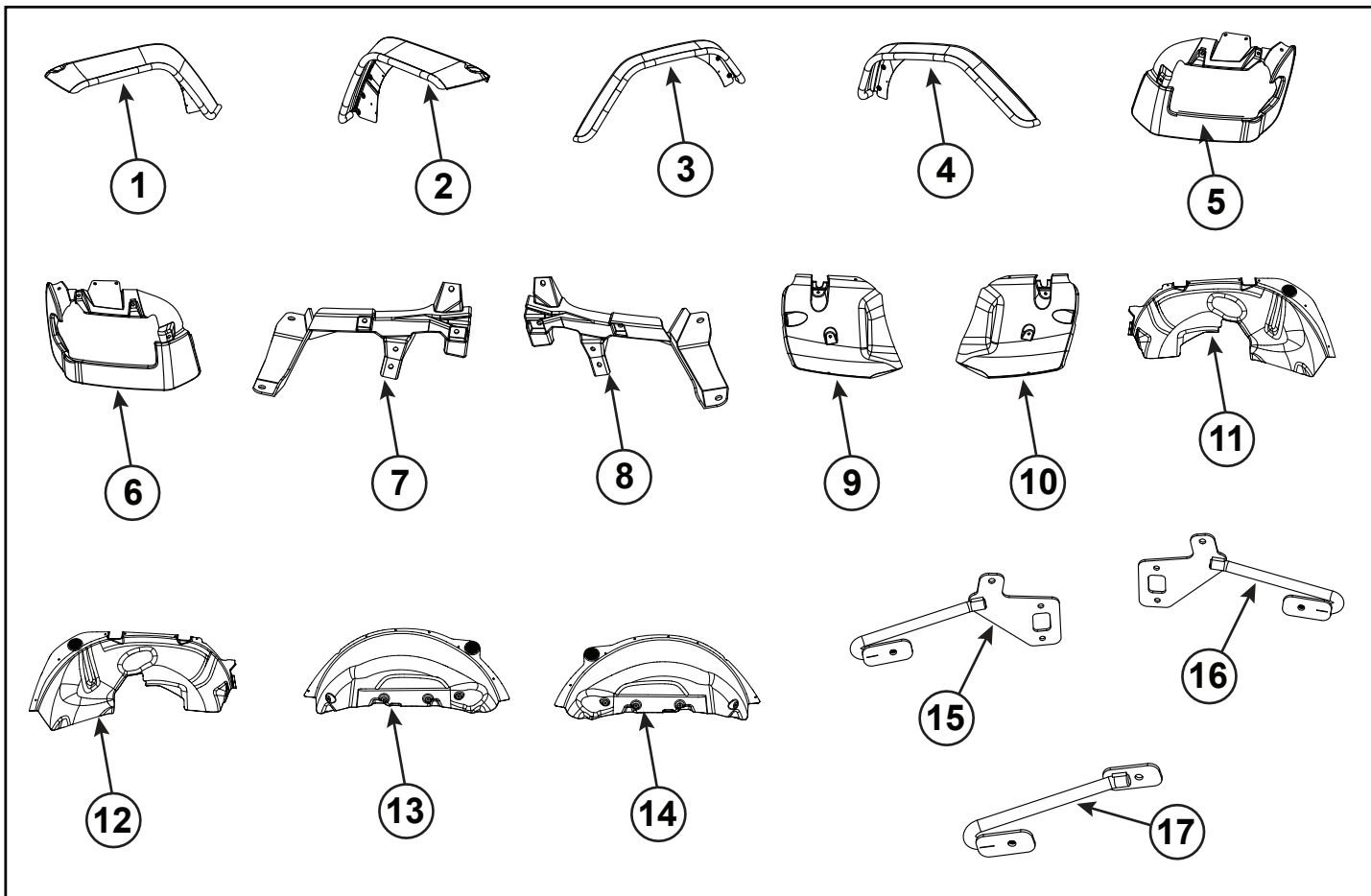

# JEEP WRANGLER METAL FENDER FLARES

www.mopar.com

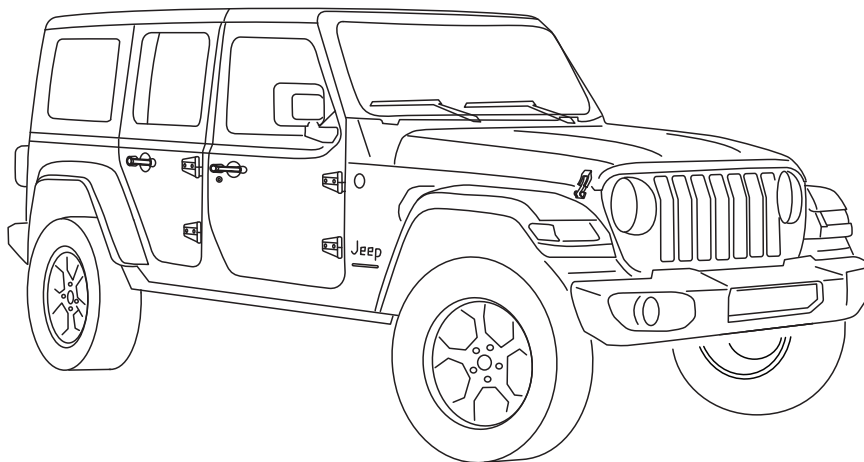

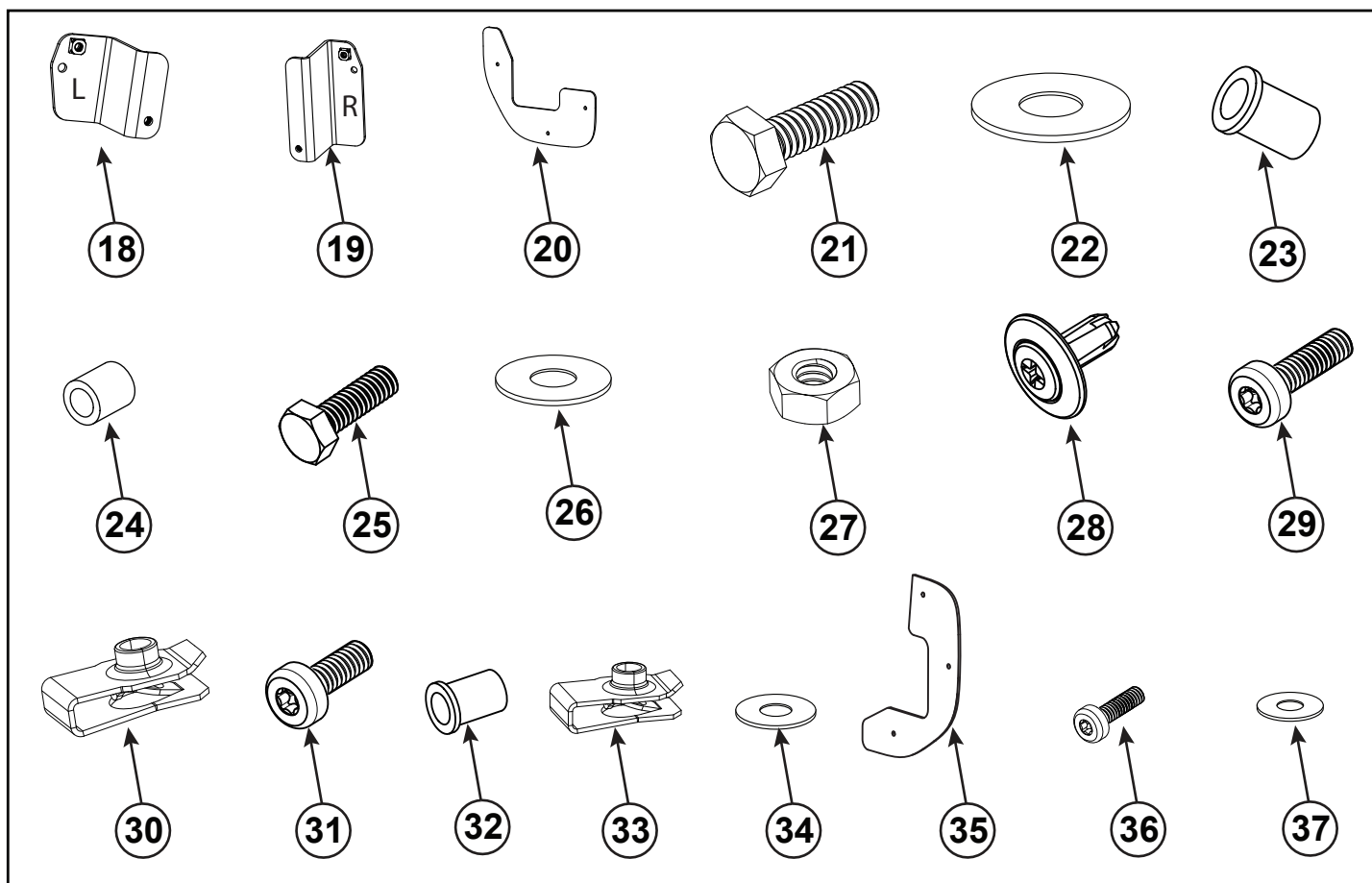

Call Out	Description	Quantity	Part Number
1	Front Flare Welded Assembly LH	1	
2	Front Flare Welded Assembly RH	1	
3	Rear Flare Welded Assembly LH	1	
4	Rear Flare Welded Assembly RH	1	
5	Lamp Moulding LH	1	
6	Lamp Moulding RH	1	
7	Lamp Support Moulding LH	1	
8	Lamp Support Moulding RH	1	
9	Lamp Backing Cover LH	1	
10	Lamp Backing Cover RH	1	
11	Front Wheel Arch Liner LH	1	
12	Front Wheel Arch Liner RH	1	
13	Rear Wheel Arch Liner LH	1	
14	Rear Wheel Arch Liner RH	1	
15	Front Support Bracket A LH	1	
16	Front Support Bracket A RH	1	
17	Front Support Bracket B	2	
18	Z Bracket LH	1	
19	Z Bracket RH	1	

Call Out	Description	Quantity	Part Number
20	Rear Bumper Close out	2	
21	M10 x 40 Bolt	8	
22	M10 Washer	8	
23	M10 Rivnut	8+2 spare	
24	Spacer	8	
25	M6 x 20 Bolt	34	
26	M6 Washer Large	30	
27	M6 Nut	12	
28	Screw Scrivet	36	
29	M6 x 20 Torx Screw Long	20	
30	M6 U - Clip	12	
31	M6 x 15 Torx Screw Short	10	
32	M6 Rivnut	22+2 spare	
33	M5 U - Clip	2	
34	M6 Washer Small	48	
35	Rear Bumper Close out	2	
36	M5x12 Torx Screw	2	
37	M5 Washer	2	

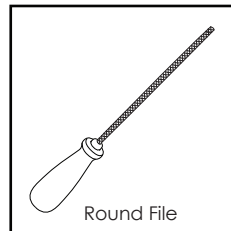
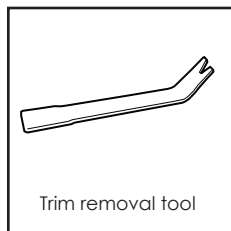
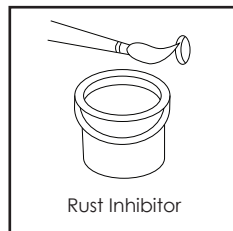
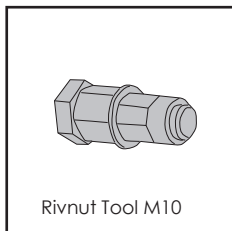
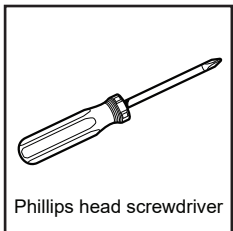
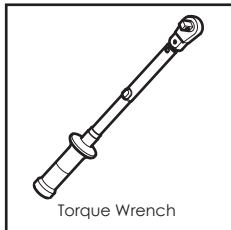
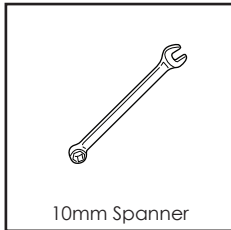
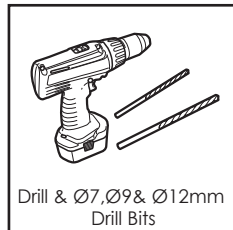
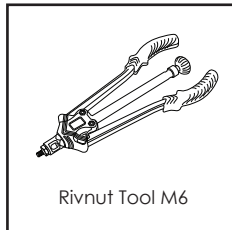
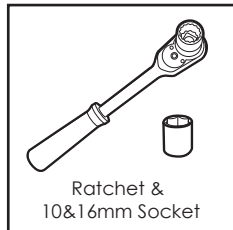
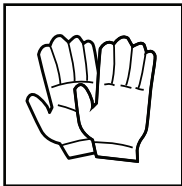
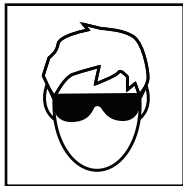

## FRONT LHS REMOVAL (RHS is mirror)

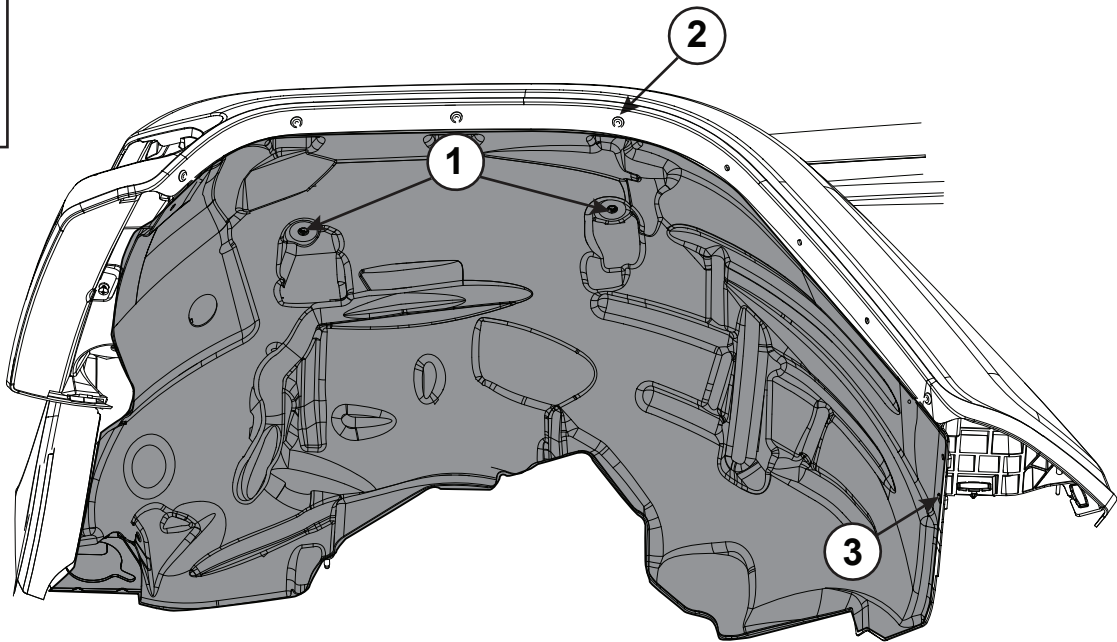
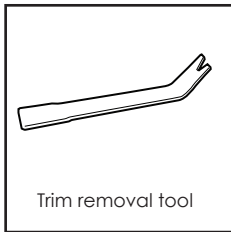

1. Disconnect and isolate the negative battery cable(s).  
Remove the wheel.  
Remove the screws (1).  
Remove and discard the push pin fasteners (3).  
Remove the rivets securing the splash shield to the flare molding (2).  
Remove the splash shield.

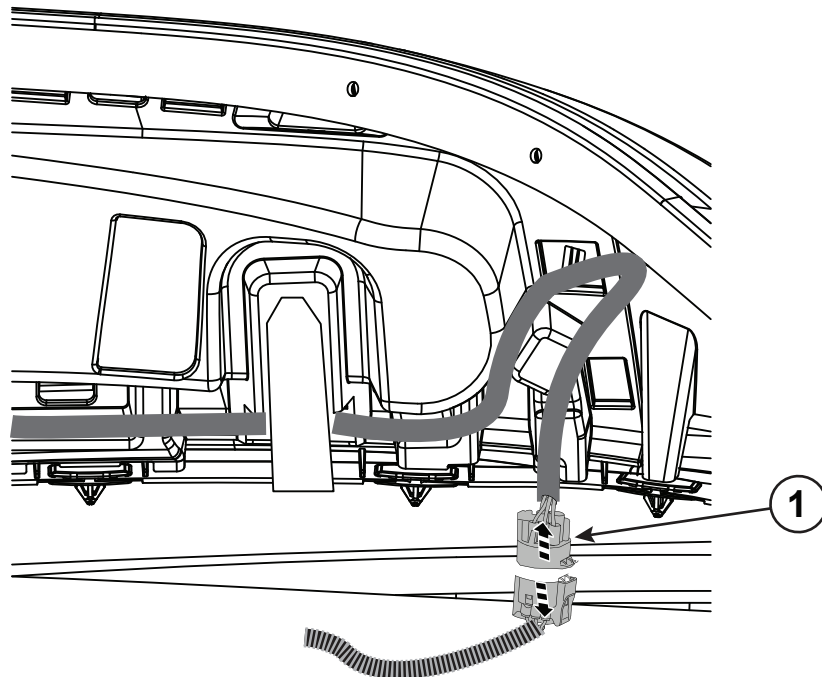

2. Disconnect the turn lamp wire harness connector (1).

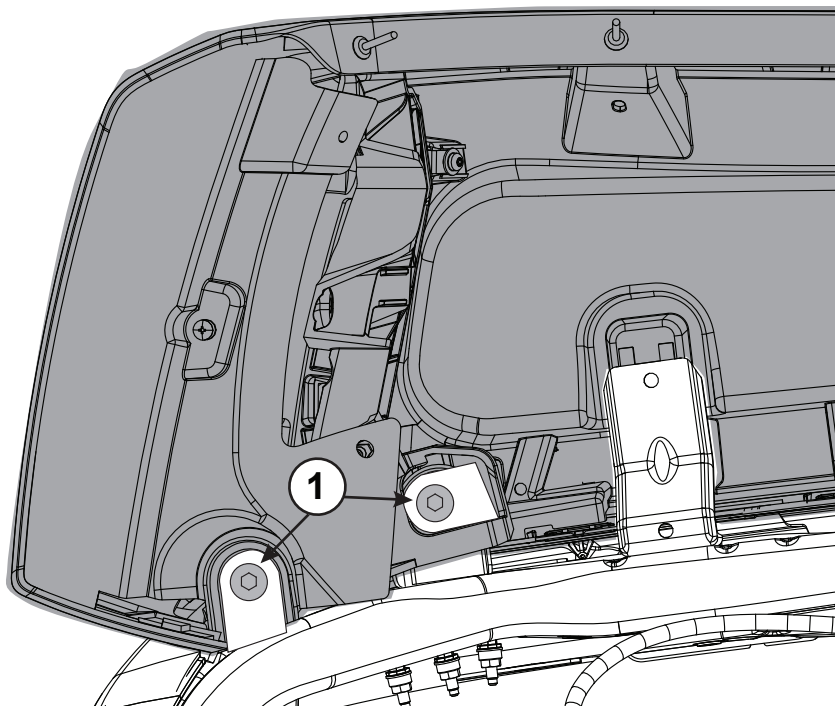
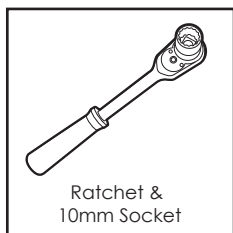

3. Remove the mounting bolts (1).

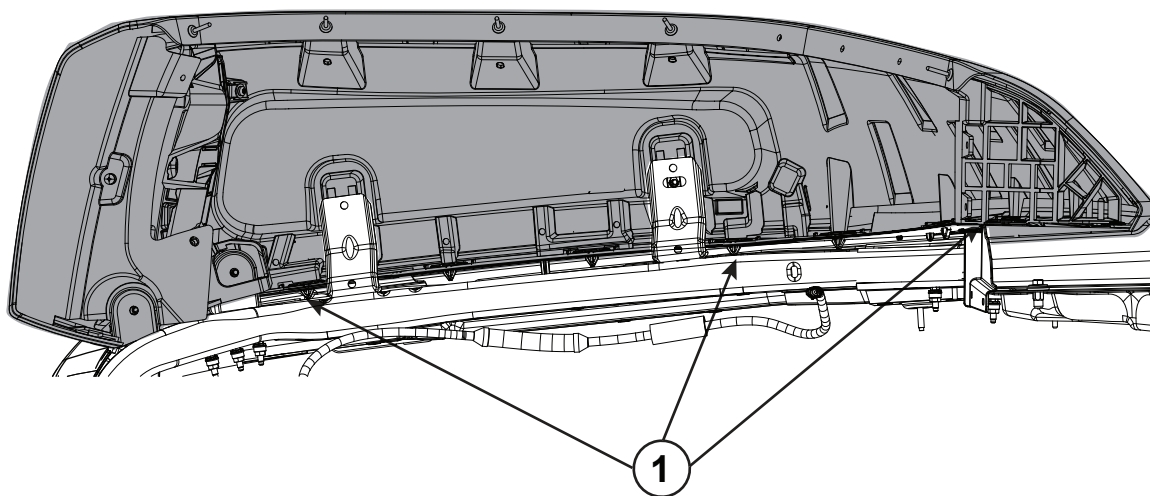
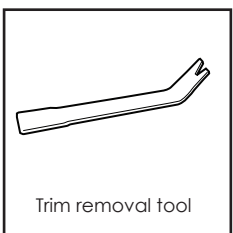

4. Using a Trim Remover, release and discard the retaining clips (1).

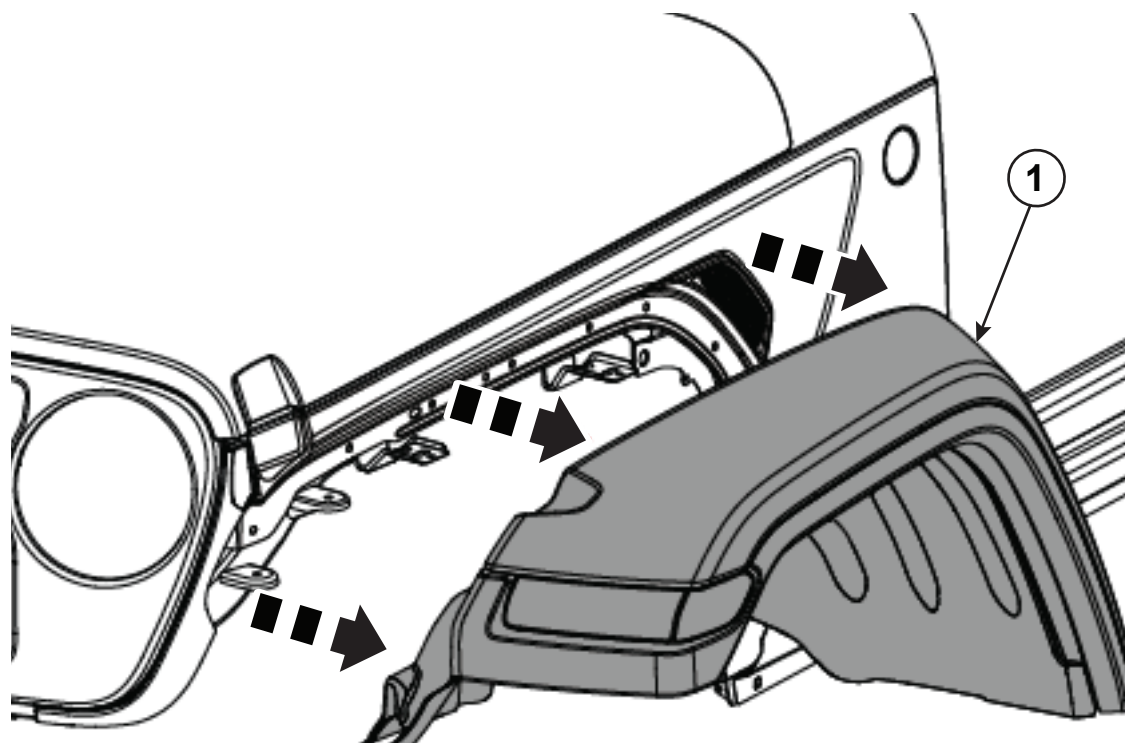

- 5.** Remove the flare molding (1).  
Remove and discard any push clips remaining in the body when the flare is removed.

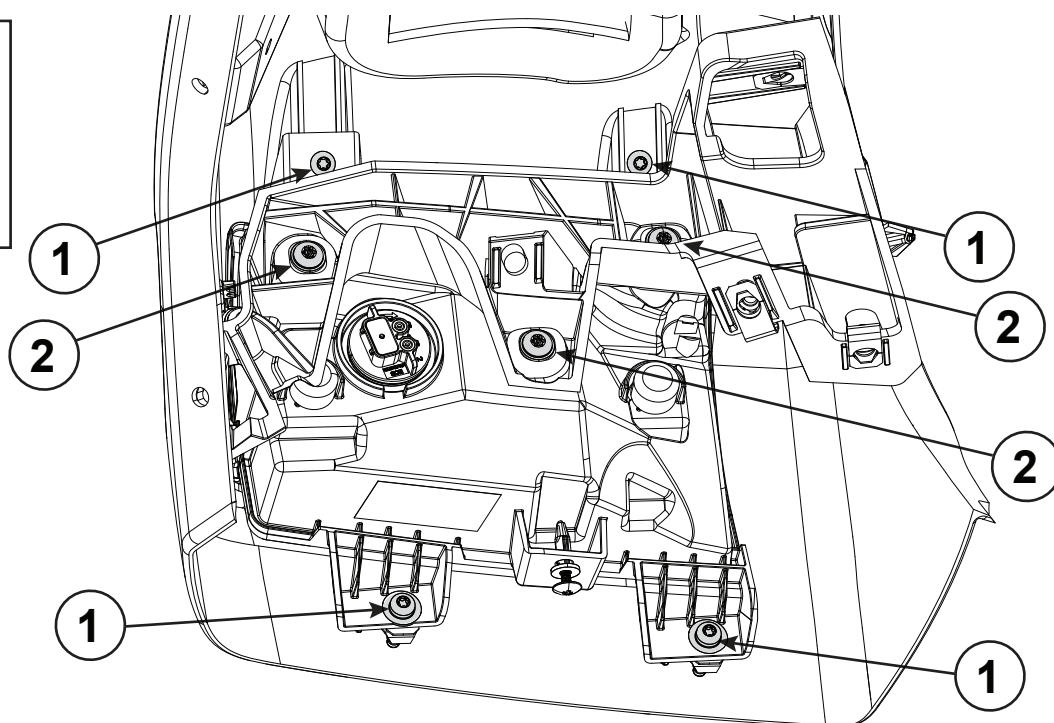
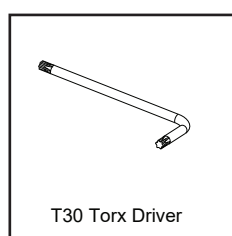

- 6.** Swing the access door out of the way to gain access to the bolts for the brace and lamp. Remove the fasteners (1) from the mounting brace.  
Remove the wire harness retainers from the inner fender.  
Remove the fasteners (2) from the lamp. Remove and retain the lamp and fixings from the vehicle.  
NOTE: Only LED lamp can be used with new Metal Fender Flares.

## REAR LHS REMOVAL (RHS is mirror)

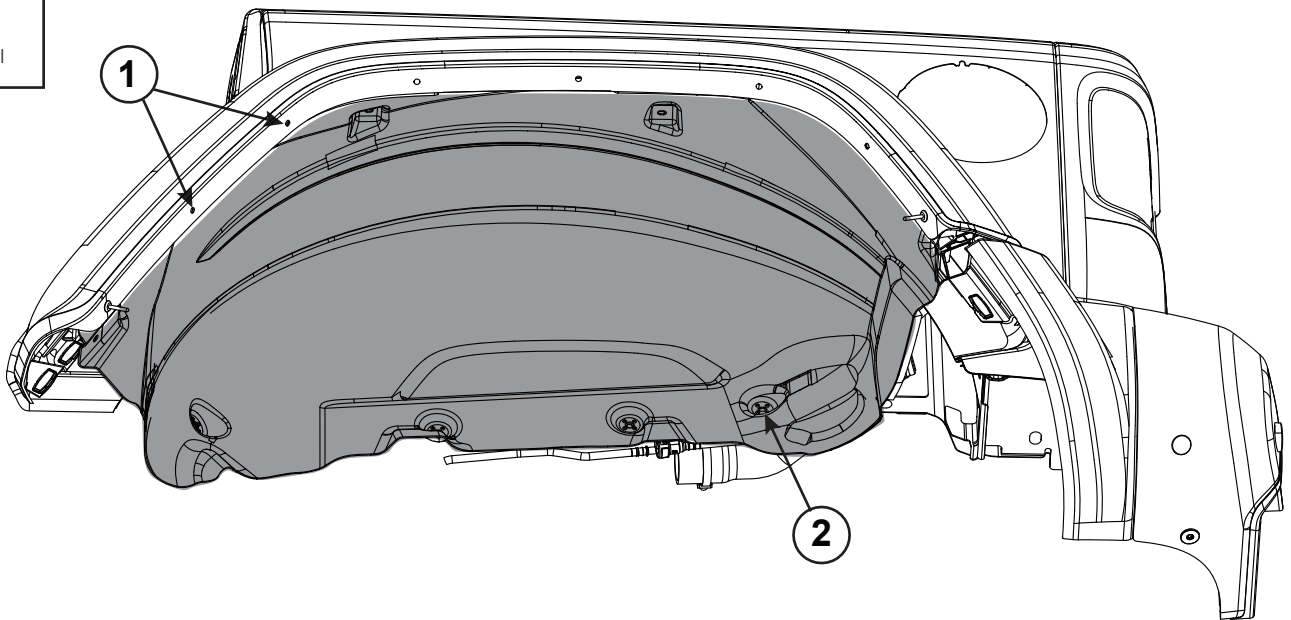
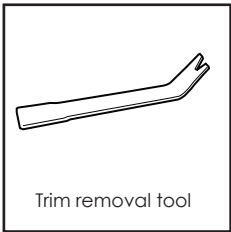

1. Remove the rivets (1) securing the splash shield to the flare molding. Remove the push pin fasteners (2) and remove the splash shield.

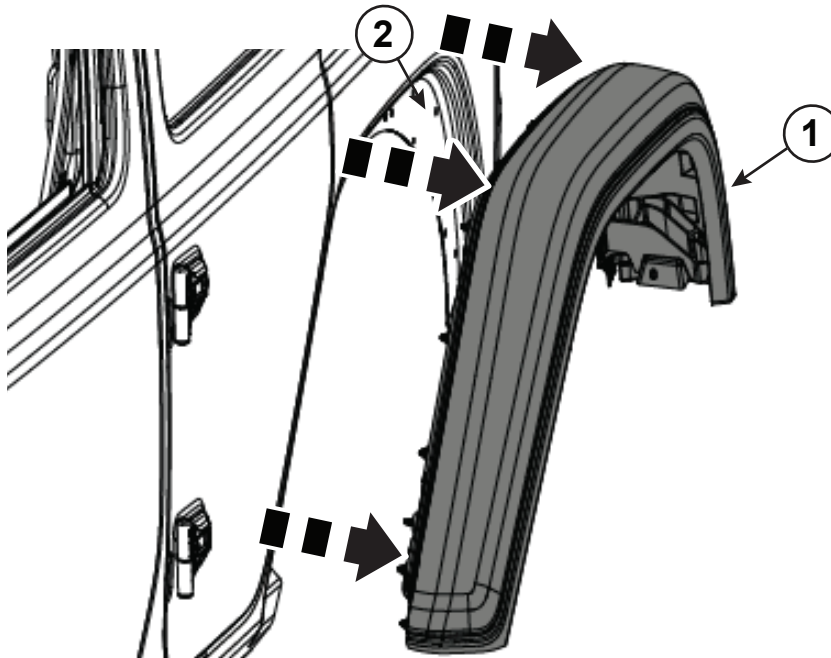
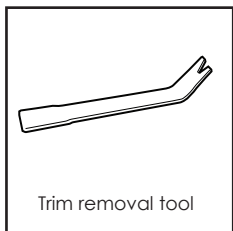

2. Using trim stick release and discard the flare molding spring retainers (2) and remove the flare molding (1).

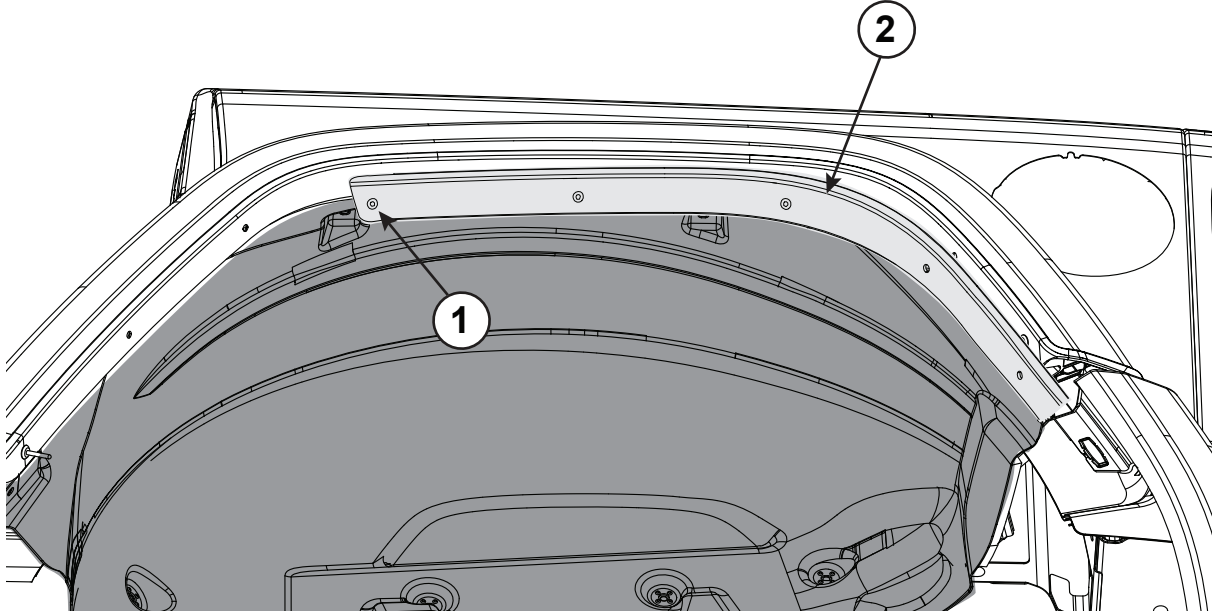

3. Remove the rivets (1) and the flare extension (2), if equipped.

FOR FENDER FLARES FITTMENT CONTINUE ON NEXT PAGE

## FRONT LHS INSTALL (RHS is mirror)

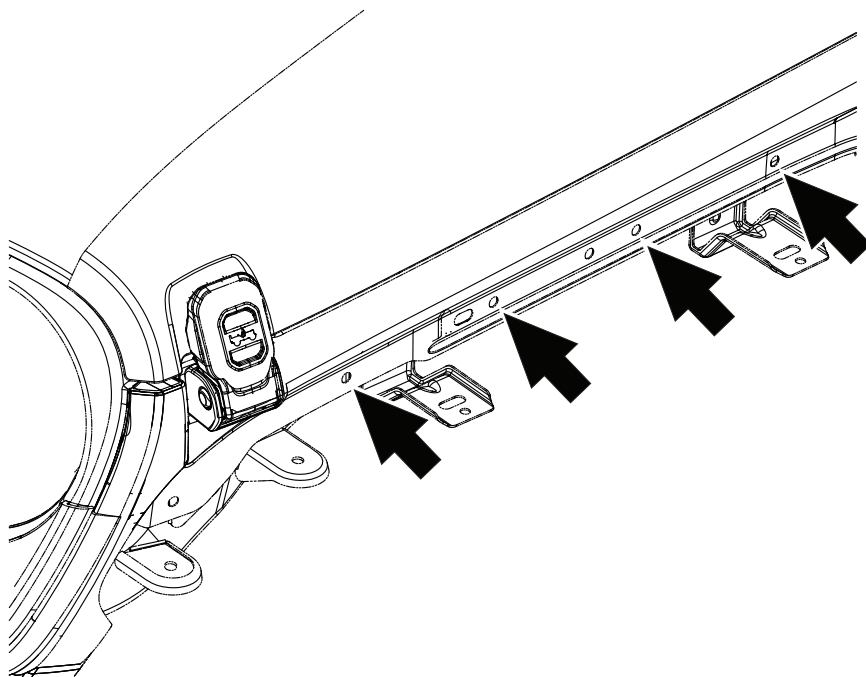
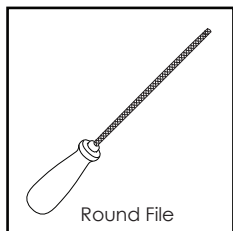

1. Locate the holes in the load beam behind the sheet metal panel at the front fender area. Drill a Ø14mm clearance hole at each 4 location as shown. Check that the hole in the sheet metal is aligned with the hole in the Load Beam at each point. If the holes are not aligned use a rotary file to elongate the hole in a horizontal direction until the hole in the beam is aligned with the hole in the sheet metal panel. Apply corrosion inhibitor to drilled holes.

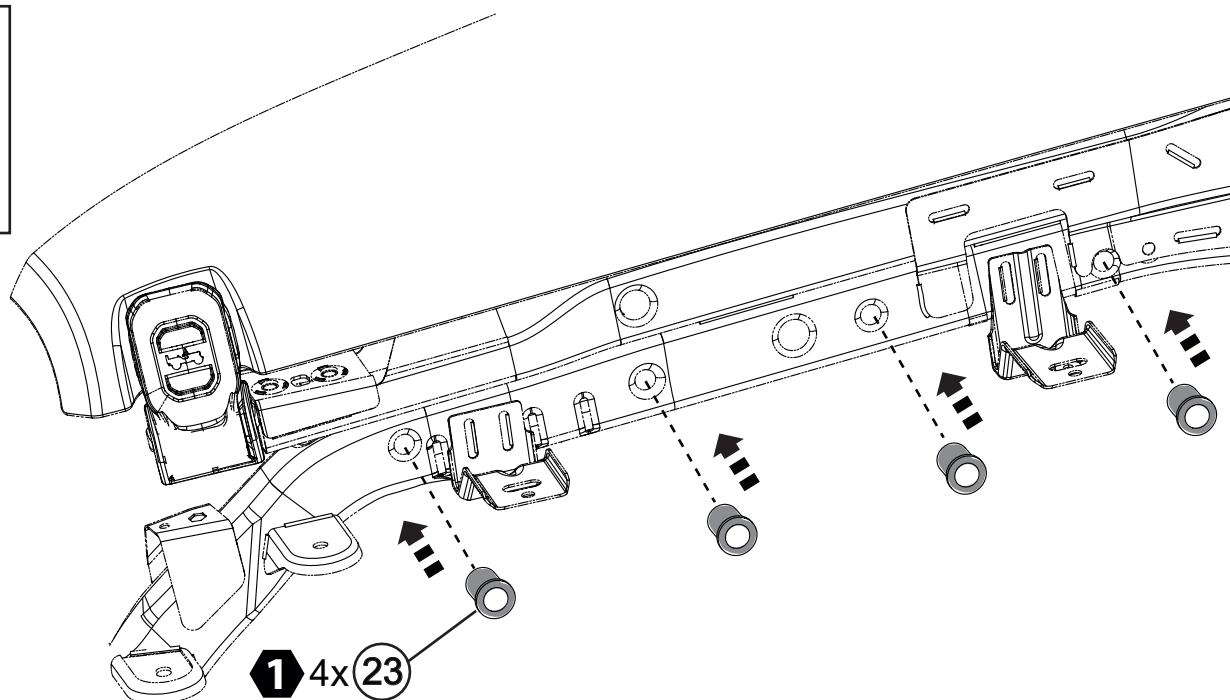
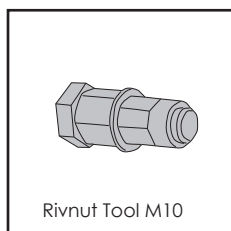

2. Install the 4 x M10 Rivnuts (23) into the lead beam behind the sheet metal panel.

**Note:** The sheet metal panel has been removed from the drawing for clarity.

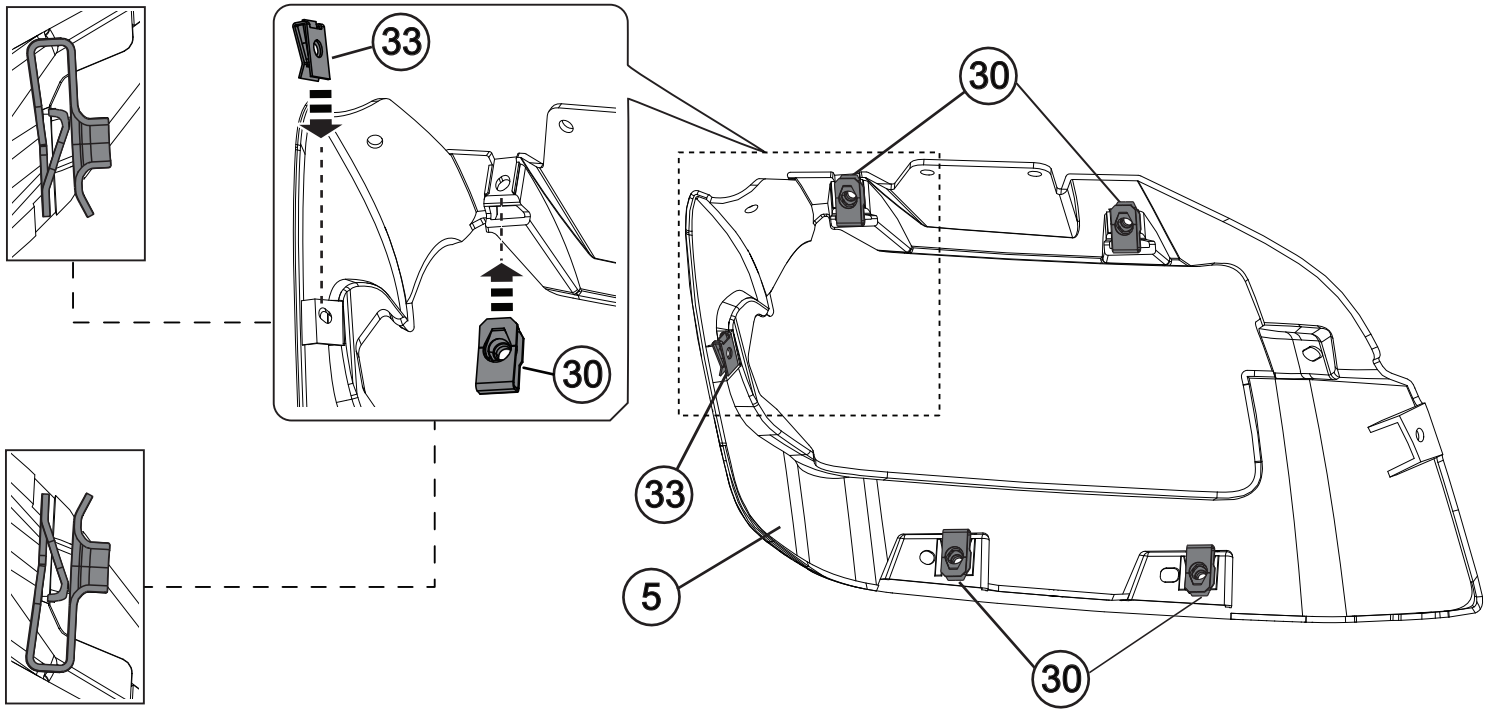

- 3.** Attach the 4 x M6 U-Clips (30) and 1 x M5 U-Clip (33) onto the Lamp Molding LH (5) by pushing it onto the tab.

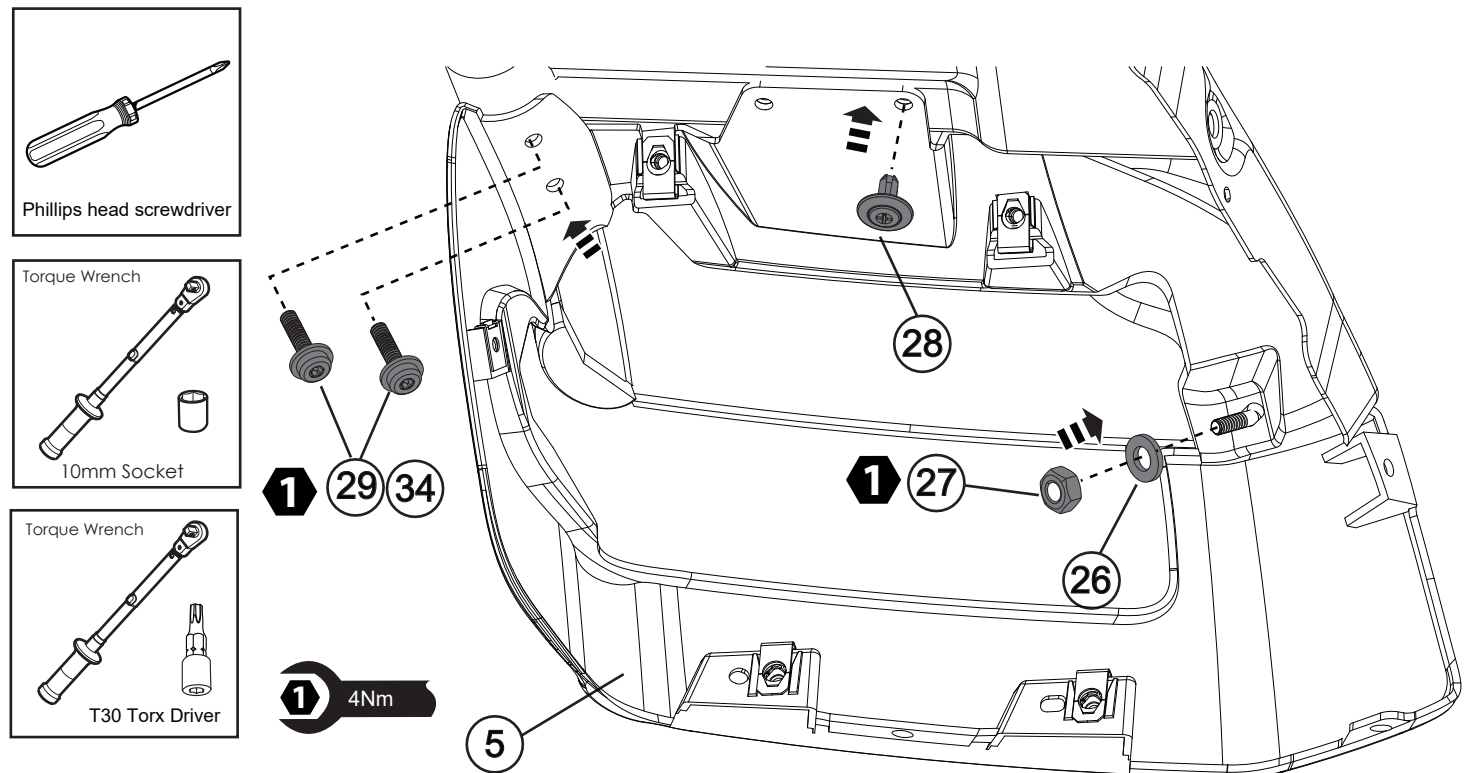

- 4.** Attach the Lamp Molding LH (5) to the Front Flare Welded Assembly LH (1) using 2 x M6 Torx Screws Long (29) and Washers (34), a Screw Scrivet (28) and an M6 Nut (27) with M6 Washer (26). Tighten the M6 Torx Screw Long (29) to 4Nm. Tighten the M6 Nut (27) to 4Nm.

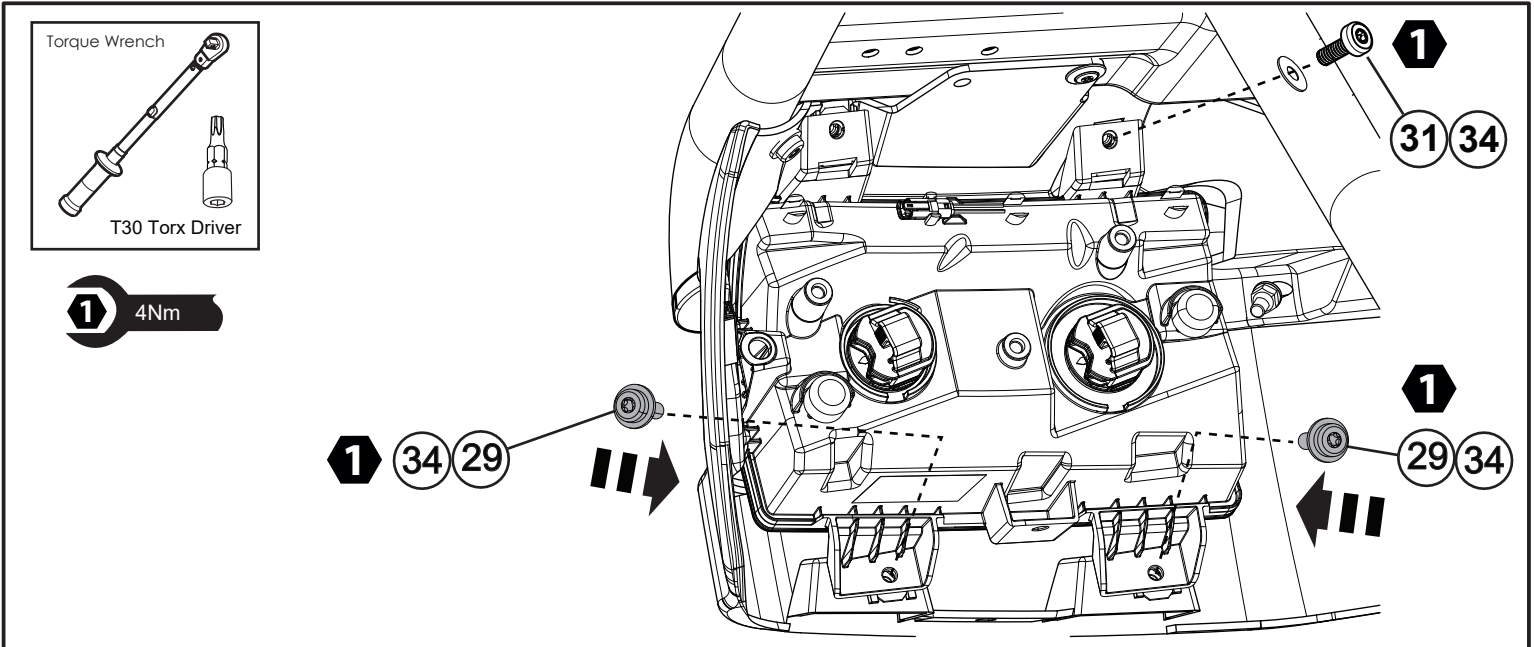

5. Install the factory lamp into the Lamp Molding LH (5) using 3 x M6 Torx Screws Long (29) and Washers (34). Install the M6 Torx Screw Short (31) and Washer (34) in the top inboard corner as shown. Tighten the M6 Torx Screws Long (29) and M6 Torx screws short (31) to 4Nm.

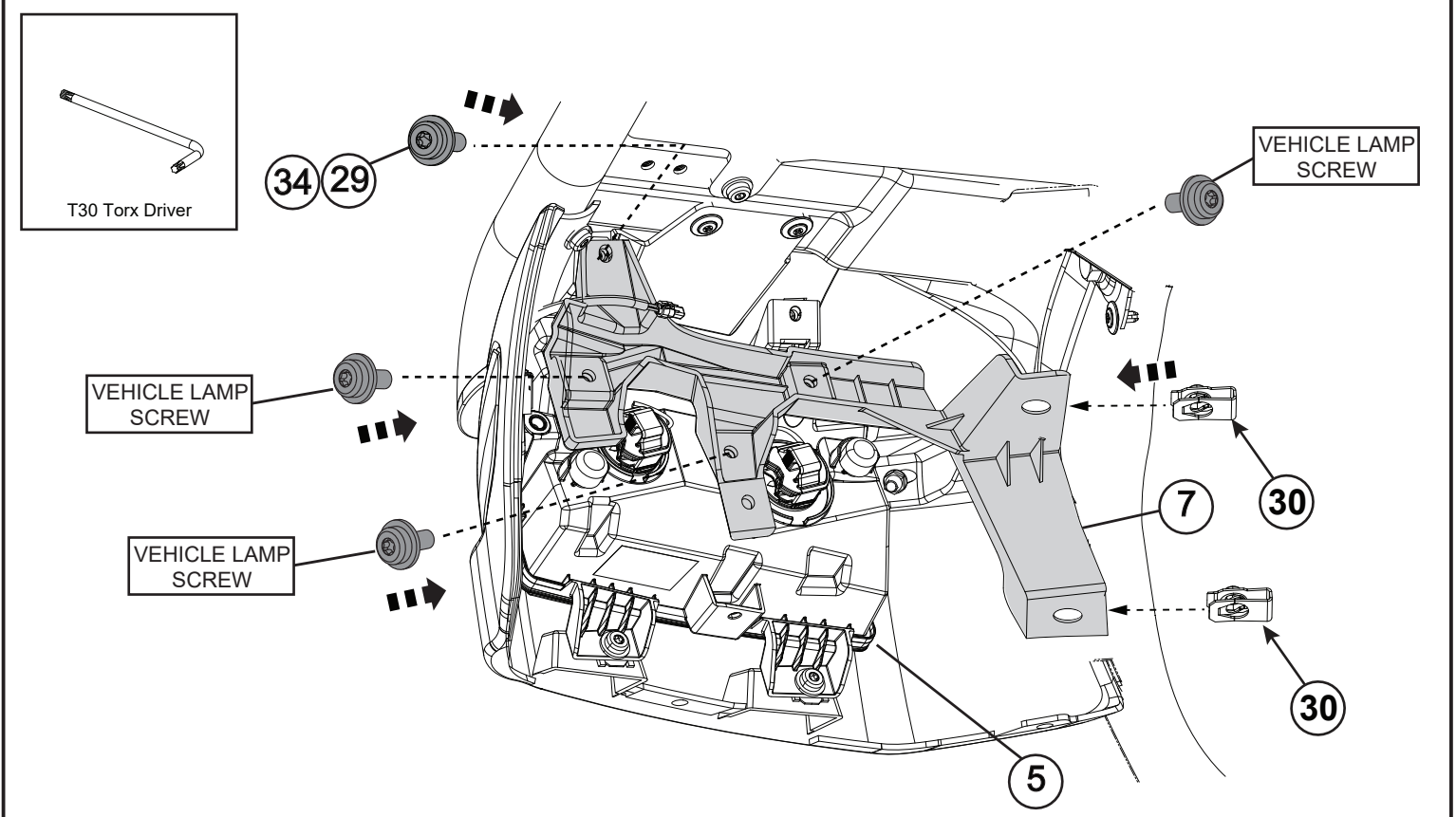

6. Install the Lamp Support Molding LH (7) into the Lamp and Lamp Molding LH (5) using the 3x Vehicle Lamp Screws retained during the lamp removal and 1 x M6 Torx Screw Long (29) and Washer (34). **Do not tighten.** Attach the M6 U-clip (30) to the Lamp Support Molding (LH) (7) by pushing it into the edge of the part at the hole position.

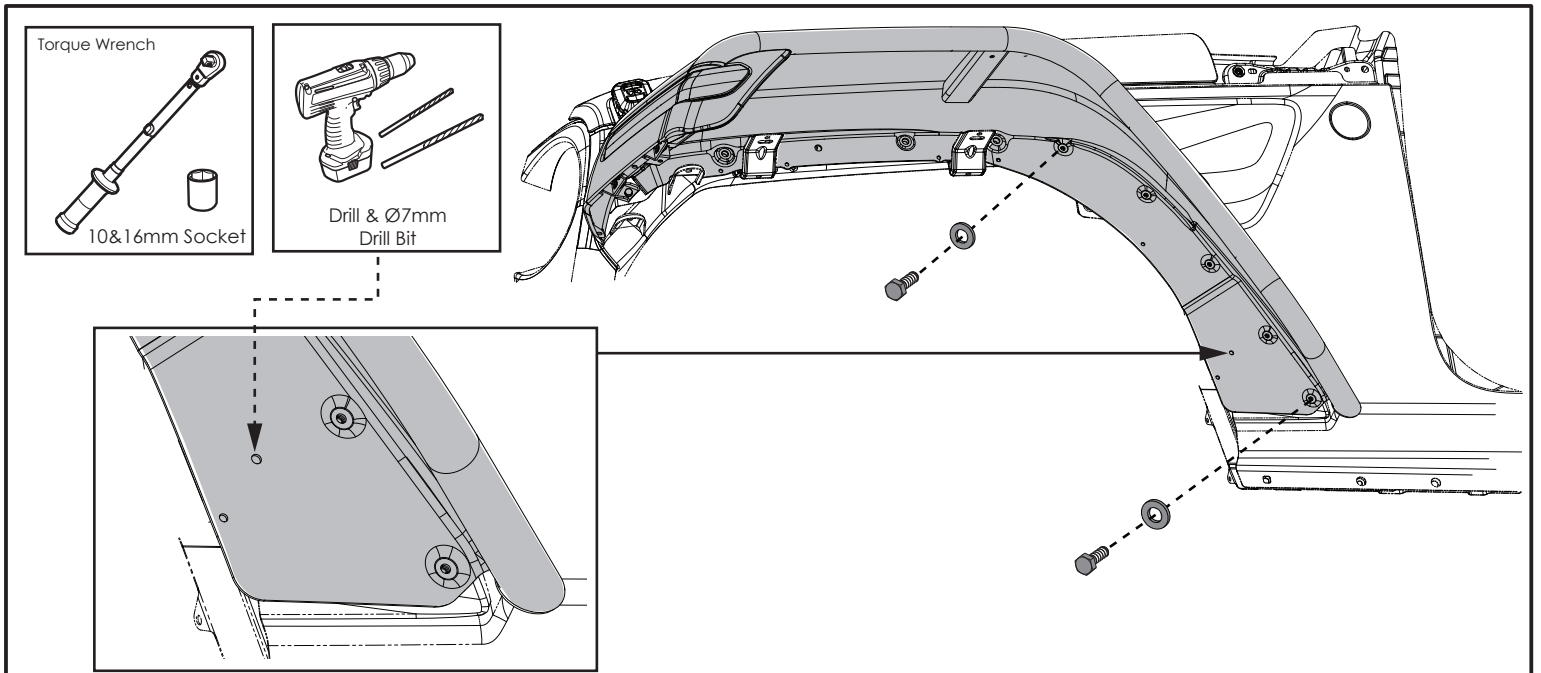

- 7.** Temporarily fit the Front Metal Flare to the vehicle and secure with two screws in locations shown. Mark the hole on the vehicle using the hole in the flare as a guide. Remove the flare. Drill the location with 7mm drill bit. Apply rust inhibitor.

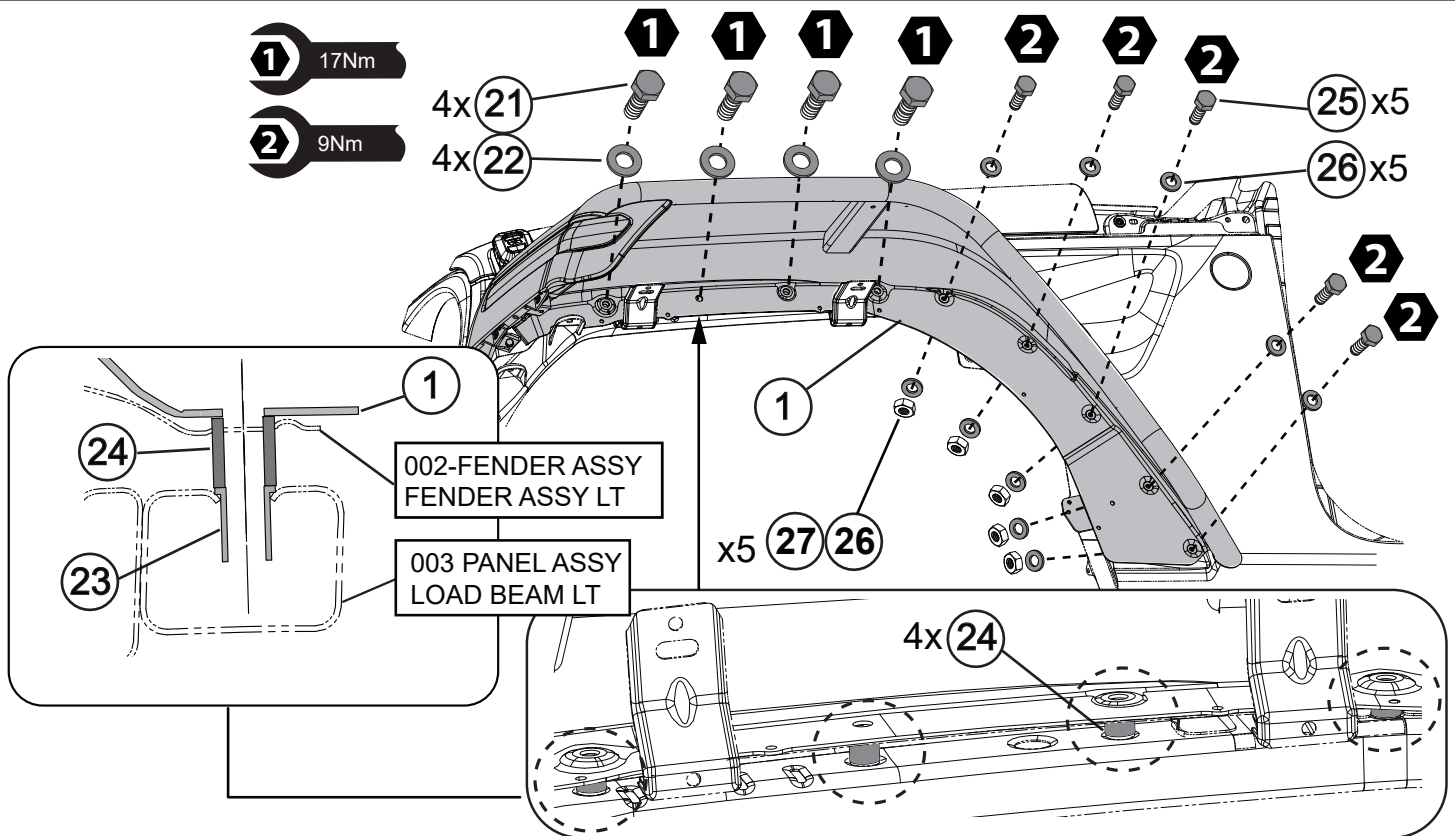

- 8.** Install the Front Flare Welded Assembly LH (1) to the vehicle using 4 x M10 Bolts (21) with 4 x M10 Washers (22) and 5 x M6 Bolts (25) with 10 x M6 Washers (26) and 5 x M6 Nuts (27). When attaching install the Spacer (24) at each M10 Bolt position. The Spacer (24) is installed between the load beam and the sheet metal (see detail views). Tighten the M10 bolts (21) to 17Nm. Tighten the M6 Bolts (25) to 9Nm.

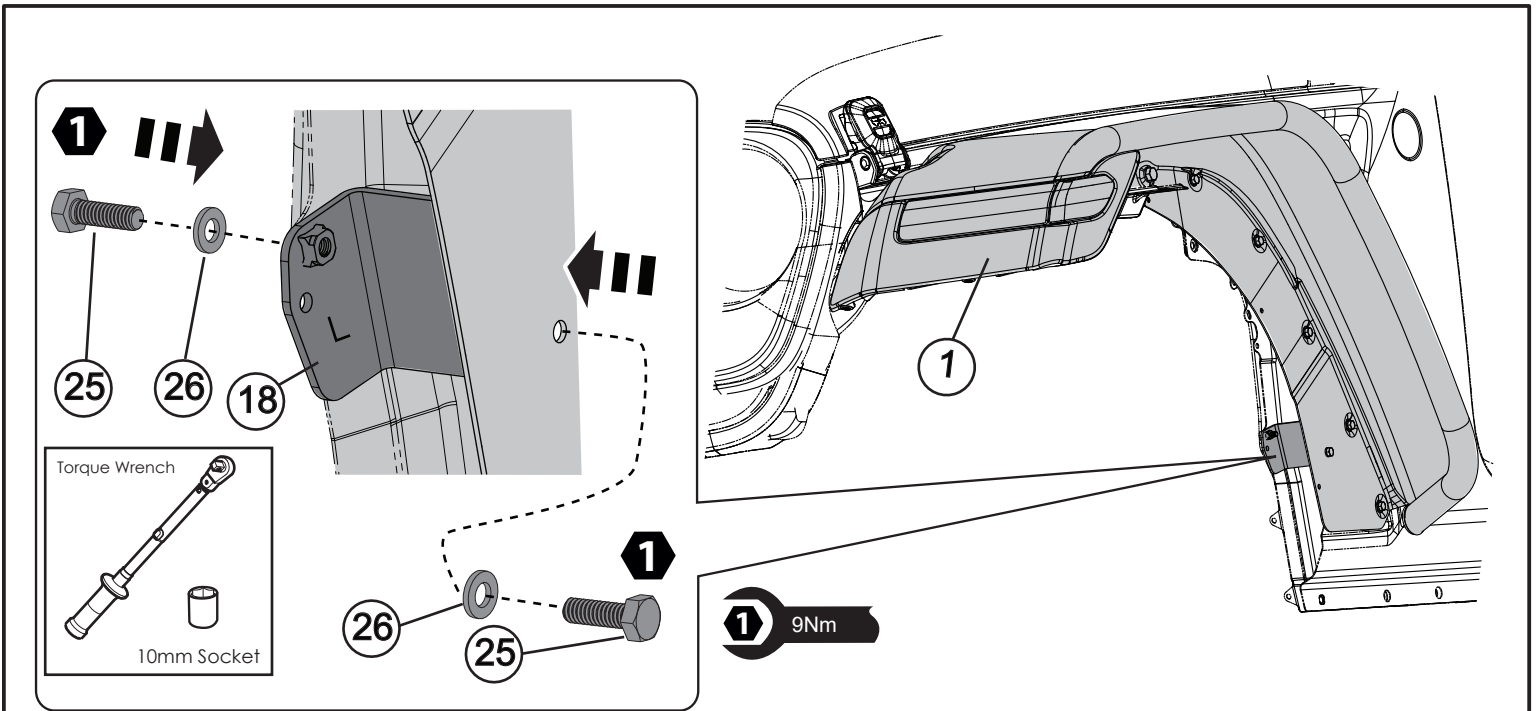

- 9.** Place the Z Bracket LH (18) between the sheet metal and the Front Flare Welded Assembly LH (1) as shown. Secure the Z Bracket LH (18) using 2 x M6 Bolts (25) with 2 x M6 Washers (26). Tighten the M6 Bolts to 9Nm.

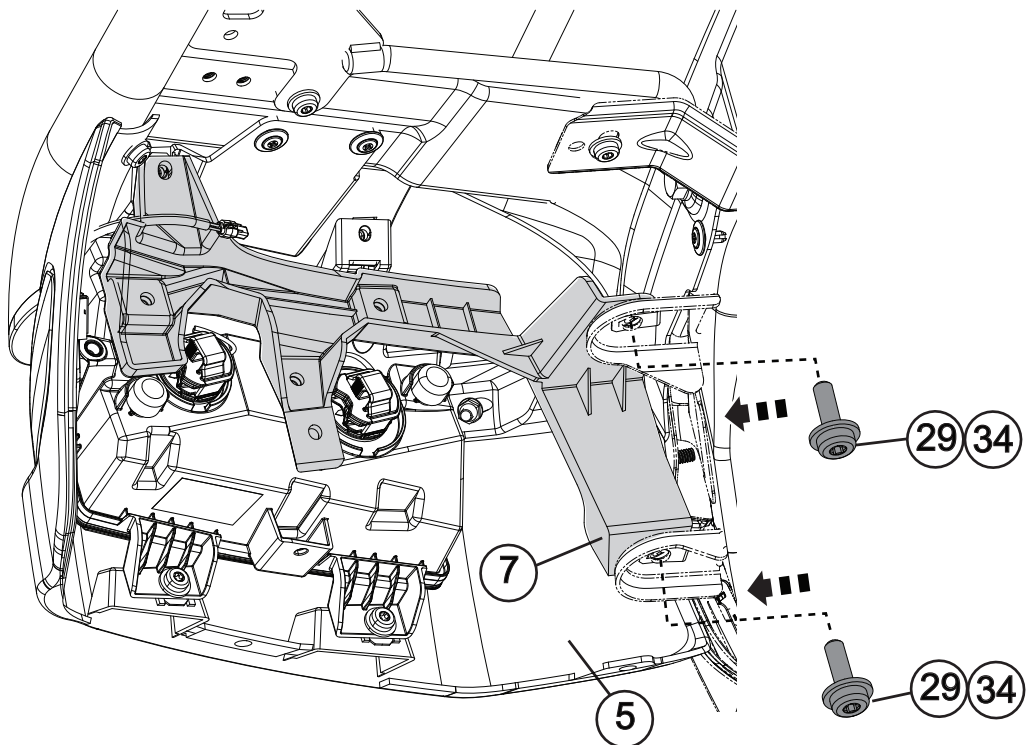
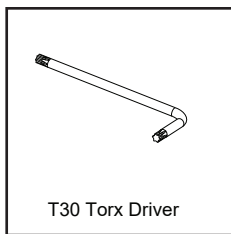

- 10.** Attach the Lamp Molding to the vehicle using 2 x M6 Torx Screws (29) Long and Washers (34).  
**Do not tighten.**

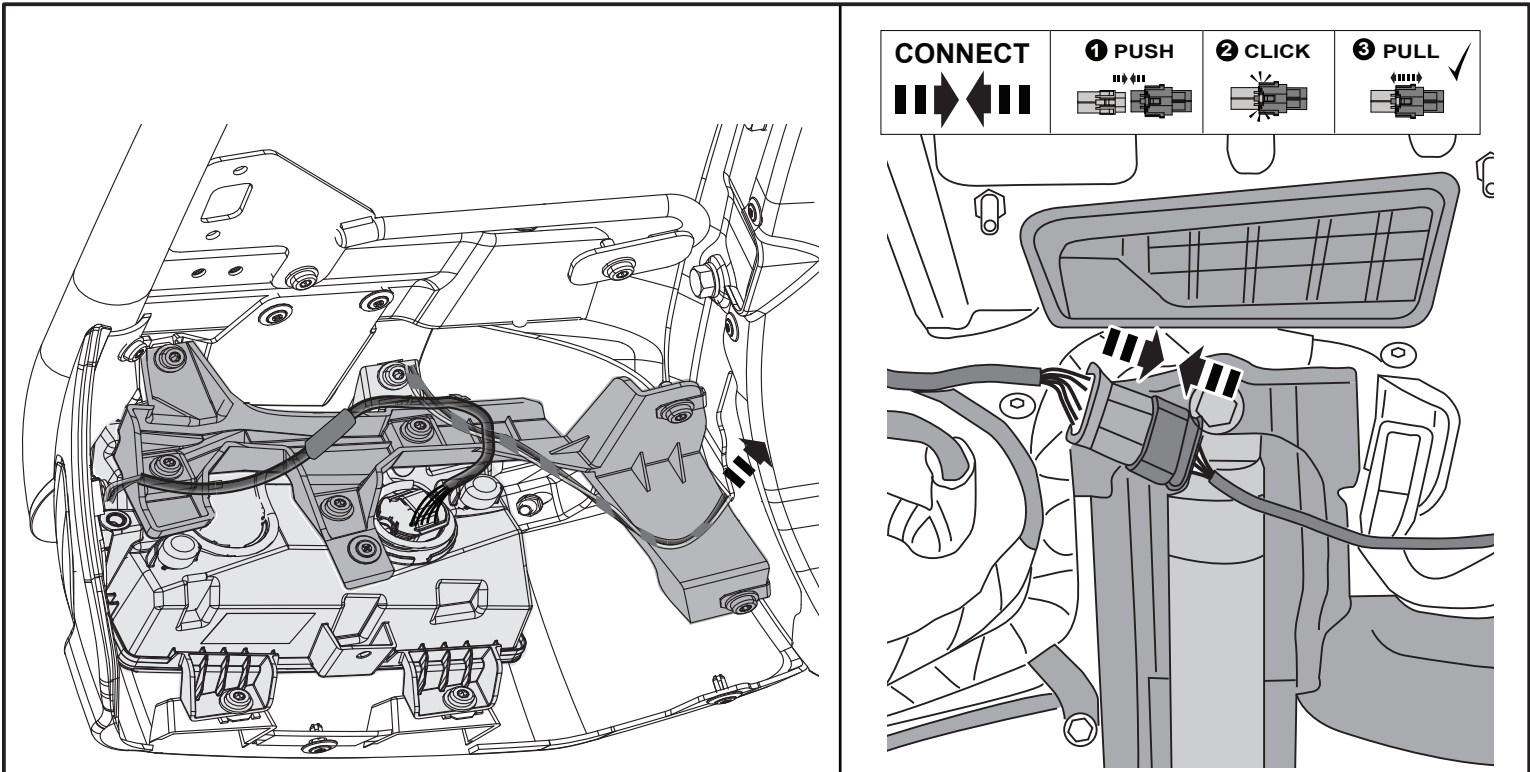

11. Route the wiring harness from the factory lamp into the engine bay as shown.

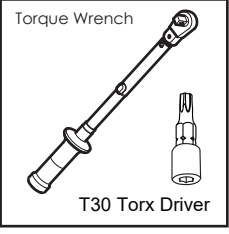

1 9Nm

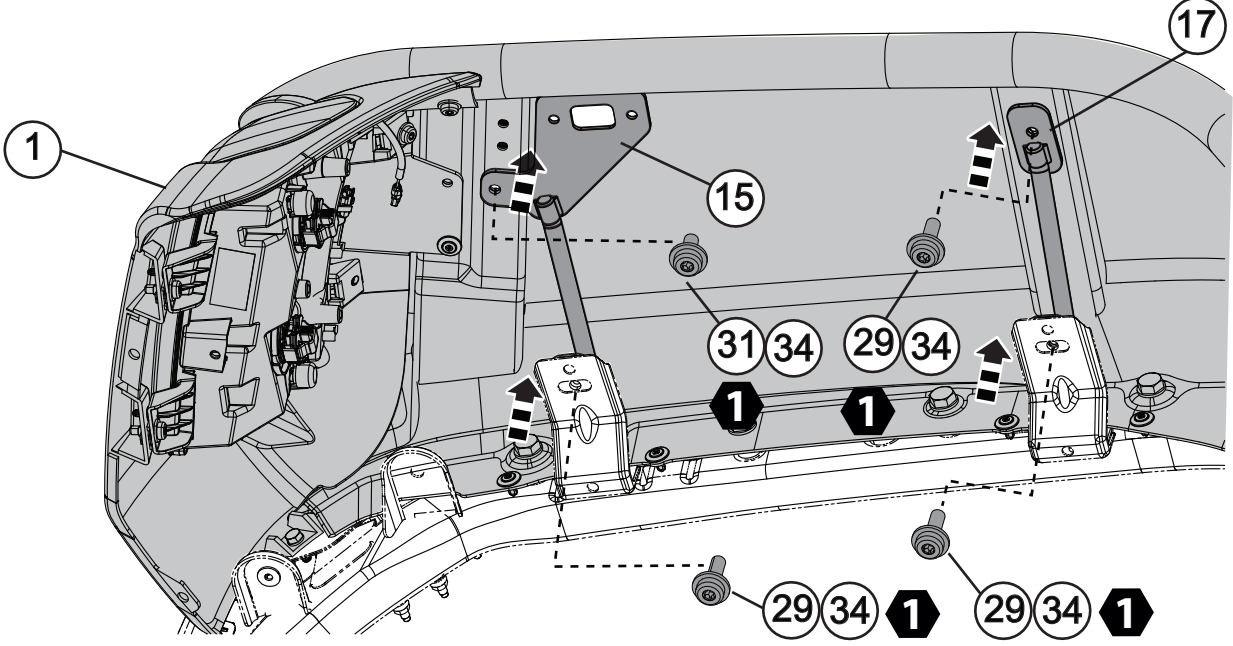

12. Install the Front Support Bracket A LH (15) and Front Support Bracket B (17) to the Front Flare Welded Assembly LH (1) and vehicle using 2 x M6 Torx Screws Long (29) and Washers (34). Attach the Front Support Bracket A LH (15) and Front Support Bracket B (17) to the Front Flare Welded Assembly LH (1) using 1 x M6 Torx Screw Long (29) with Washers (34) and 1 x M6 Torx Screws Short (31). Tighten the M6 Torx screw Long (29) and M6 Torx screw Short (31) to 9Nm.

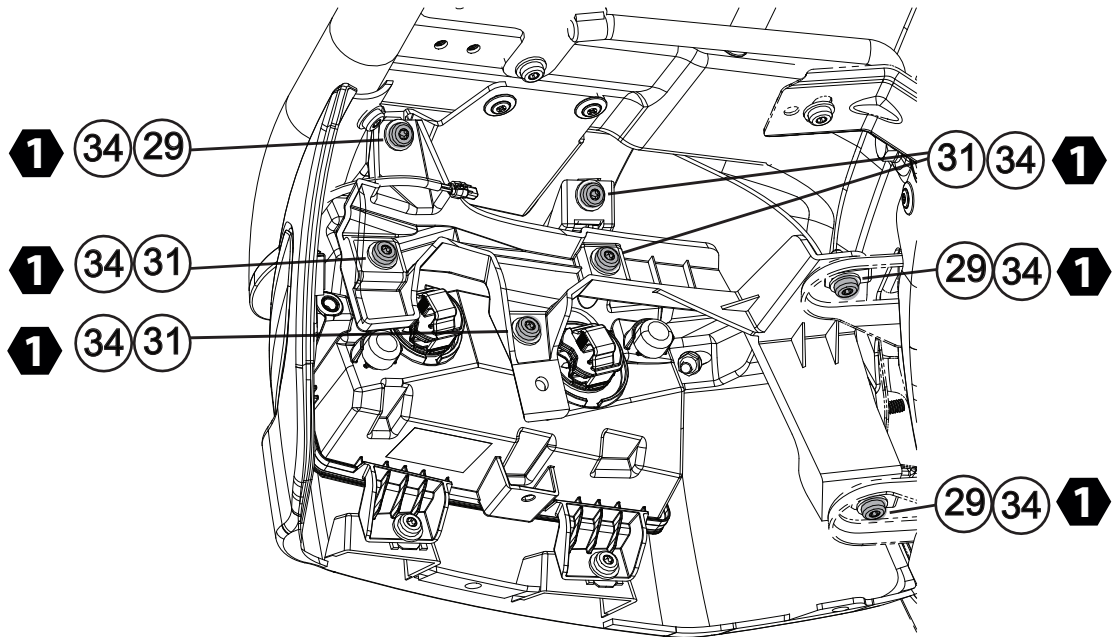
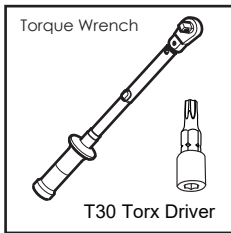

- 13.** Tighten the 4 x M6 Torx Screws Short (31) with Washers (34) and 3 x M6 Torx Screw Long (29) with Washers (34) to 3.3Nm.

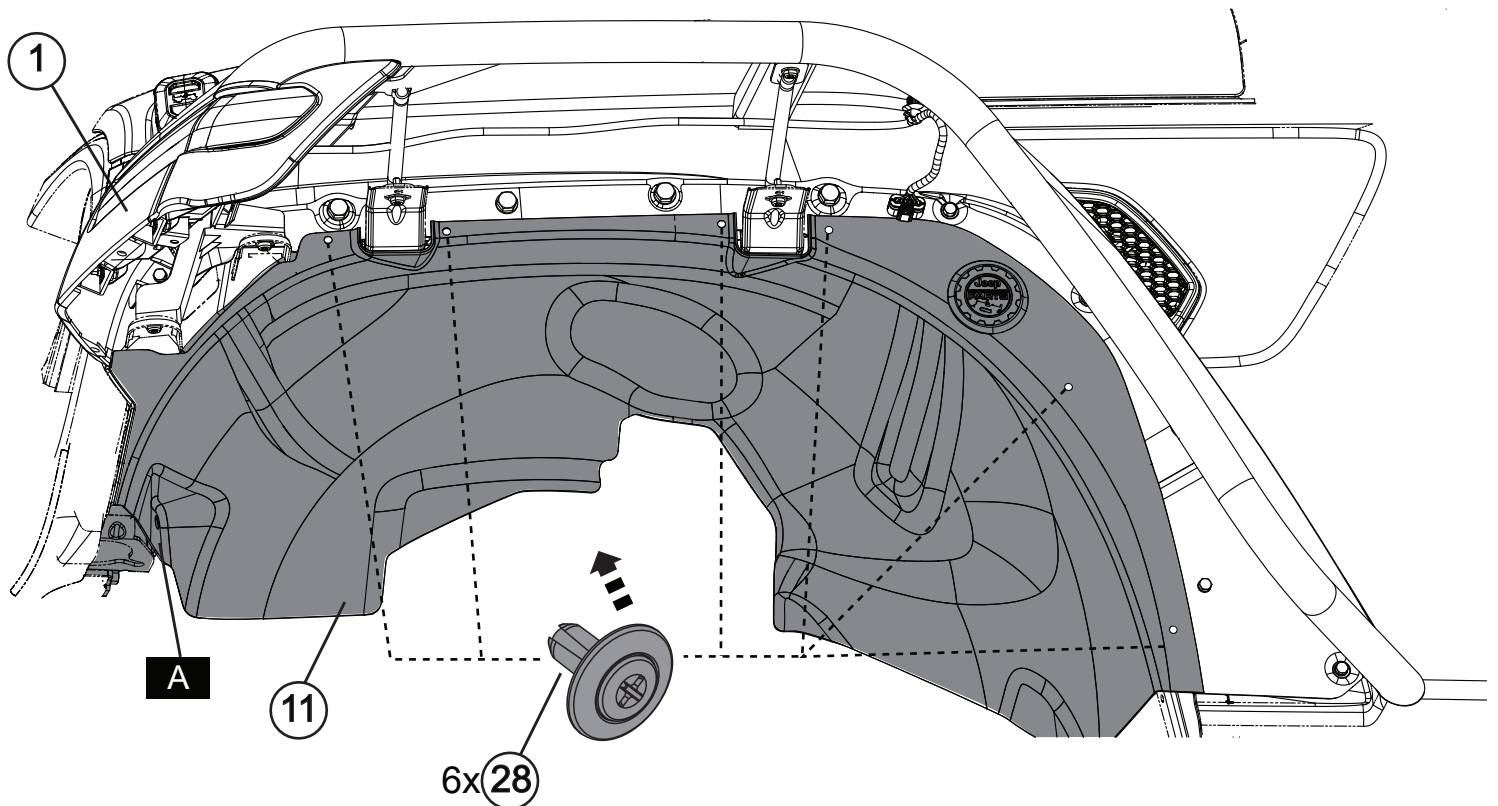

- 14.** Install the Front Wheel Arch Liner LH (11) into the Front Flare Welded Assembly LH (1) and secure using 6 x Screw Scrivet (28).  
Re-install the push clips dis-assembled from the factory liner retained earlier into Position A.

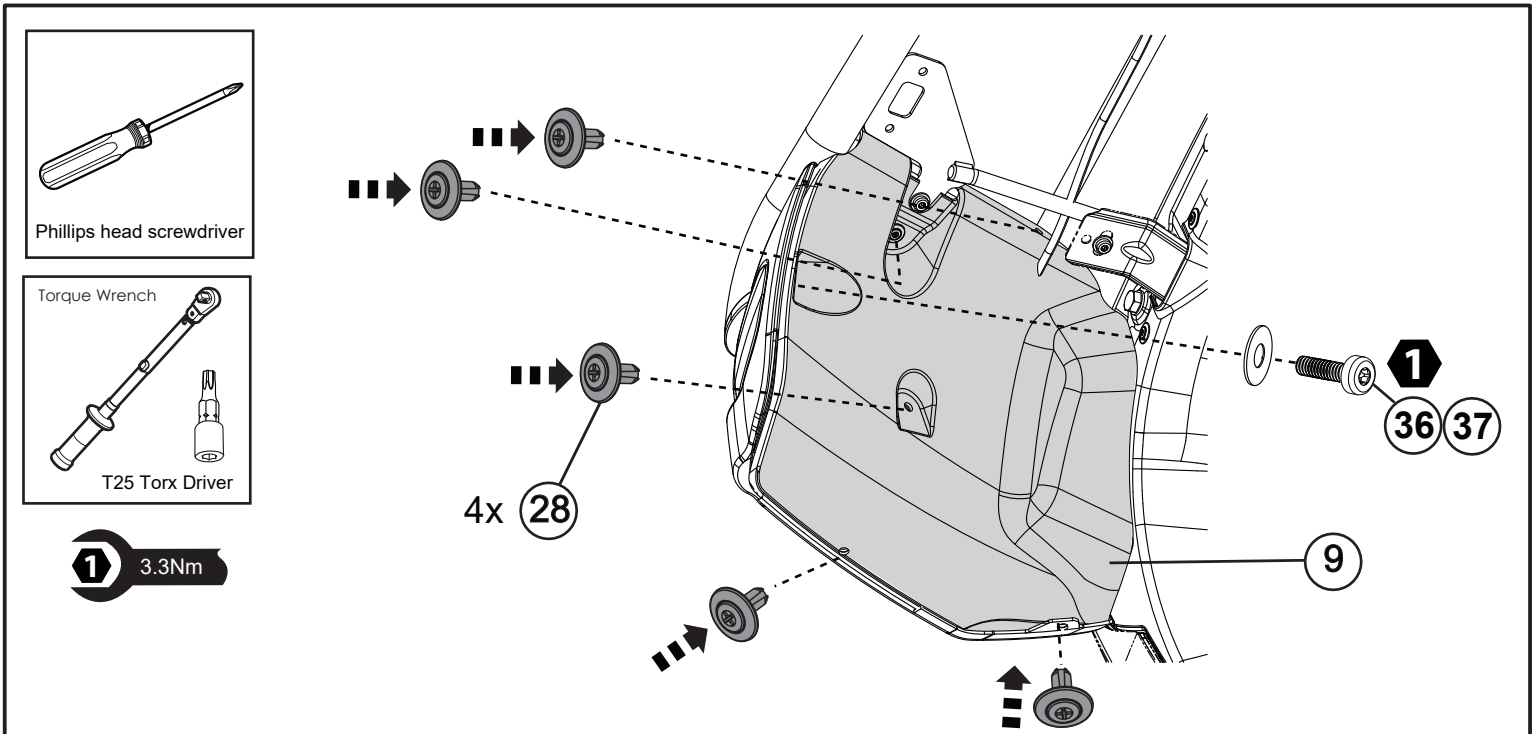

**15.** Install the Front Lamp Backing Cover LH (9) into the Front Flare Welded Assembly LH (1) using 5 x Screw Scrivet (28) and 1 x M5 screw (36) with M5 Washer (37).

### REAR LHS INSTALL (RHS is mirror)

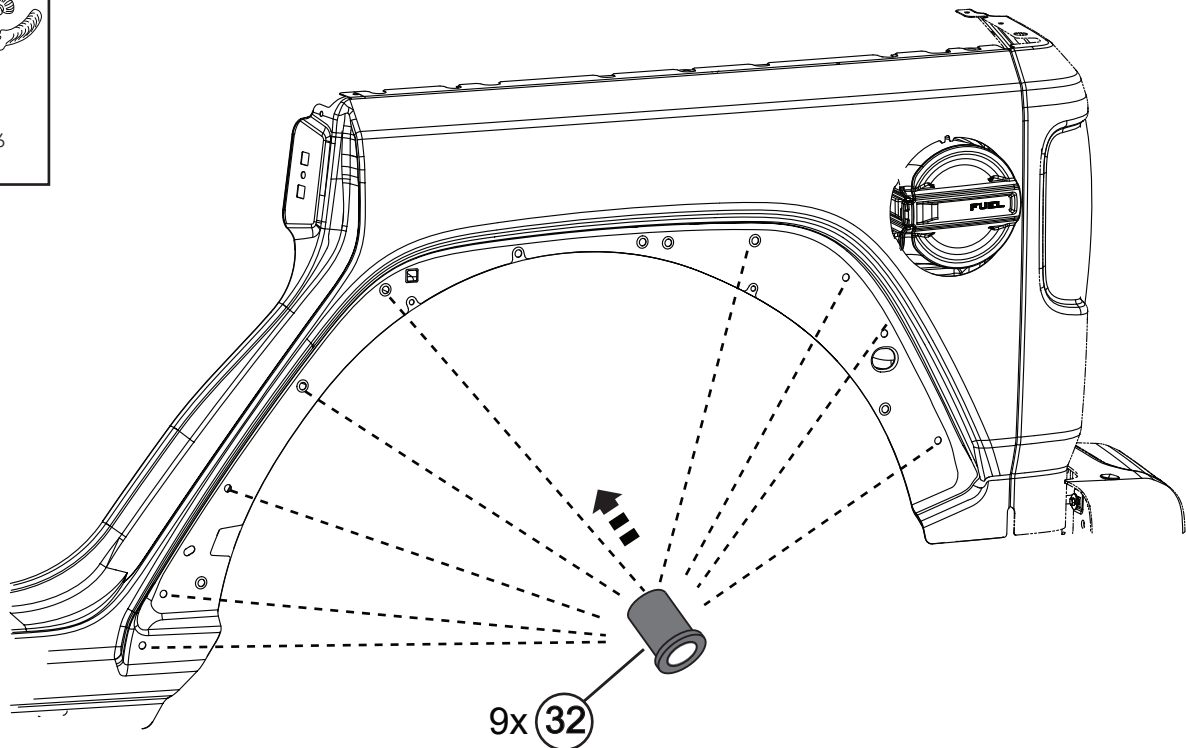
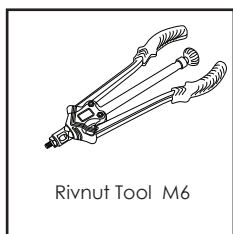

**1.** Install the M6 Rivnuts (32) in the 9 positions shown on the body.

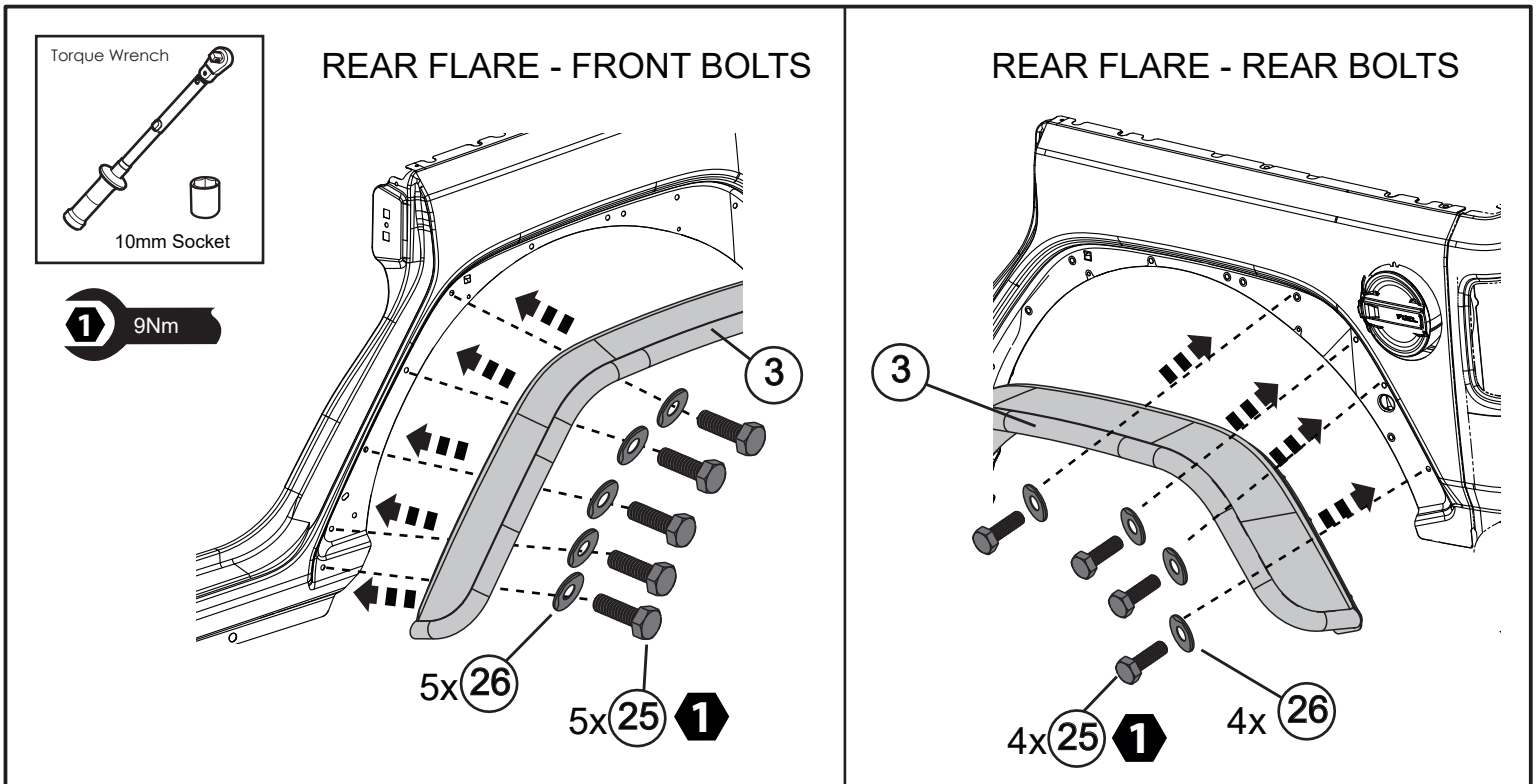

- 2.** Install the Rear Flare Welded Assembly LH (3) using 9 x M6 x 20mm Hex Head Bolts (25) and 9 x M6 Washer (26). Tighten the bolts to 9Nm.

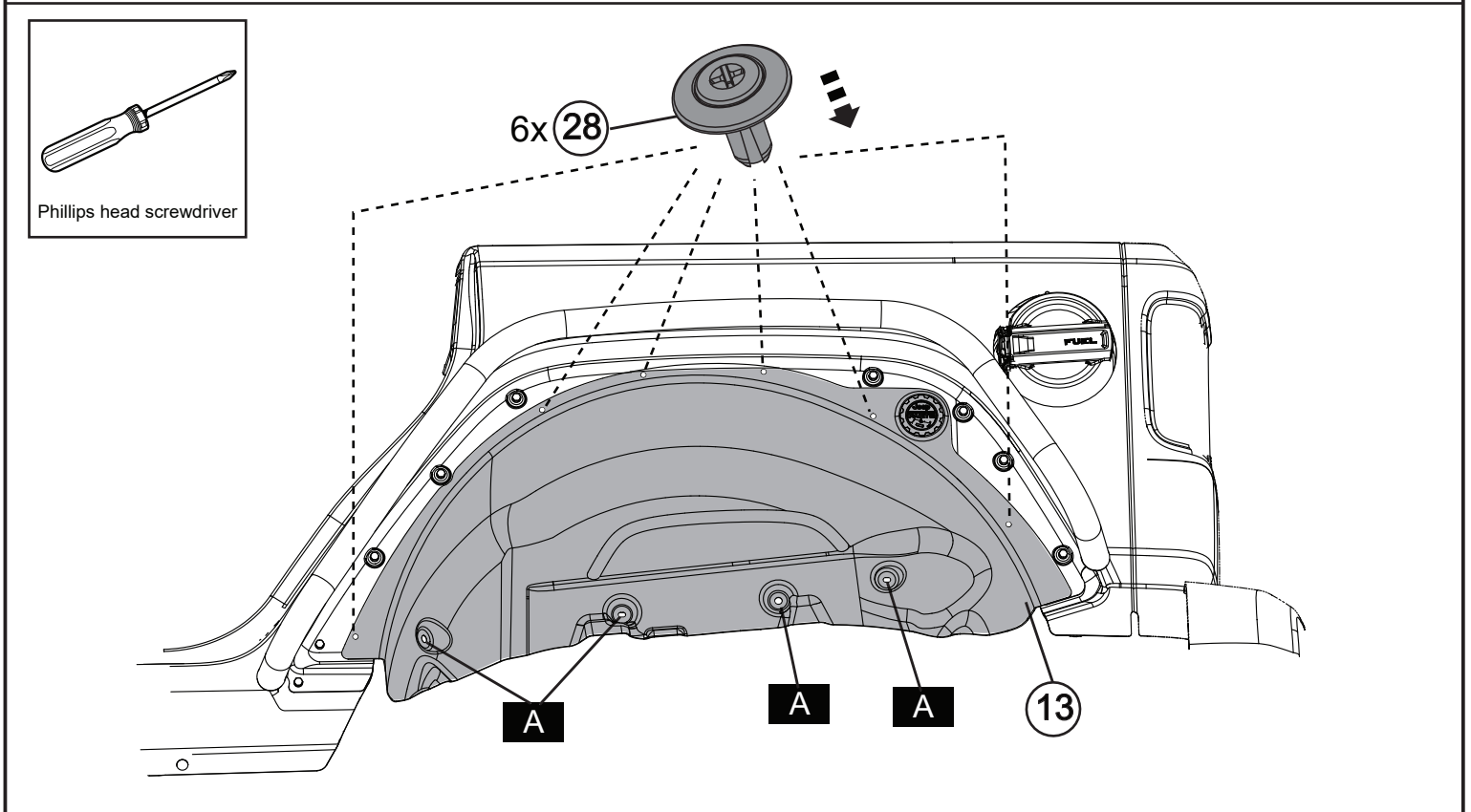

- 3.** Install the Rear Wheel Arch Liner LH (13) into the Rear Flare Welded Assembly LH (3) using 6 x Screw Scrivet (28).  
Re-install the push pin fasteners dis-assembled from the factory liners retained earlier into Positions A.

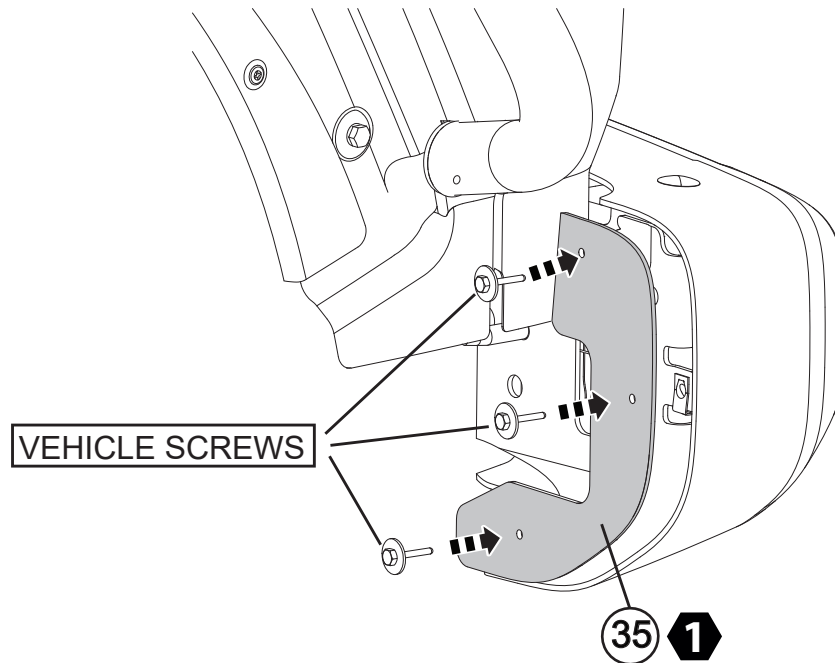
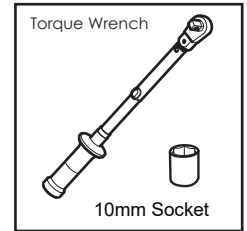
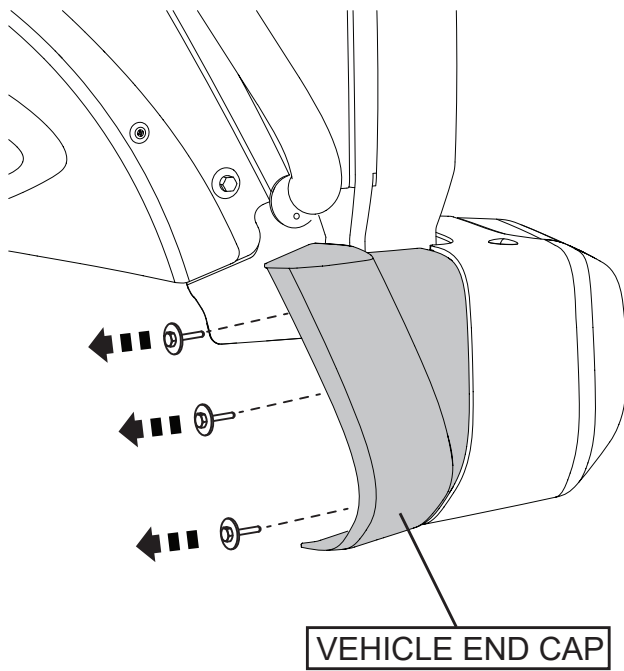

- 4.** The Metal Fender Flares can be installed with the vehicle end cap as shown OR If a more rugged looks is desired the vehicle end cap can be removed following the steps below. Remove the vehicle end cap by removing the 3 x screws securing it to the rear bumper. Retain the screws. Install the Rear Bumper Closeout (35) to the Bumper using the 3 x vehicle screws. Tighten the screws to 4 Nm. RH shown, repeat for LH.