

Please read and understand these instructions fully before starting any work.
These instructions **MUST** only be carried out by a fully qualified and competent person.

Nomeclature

Tooling required:
13mm spanner x 2

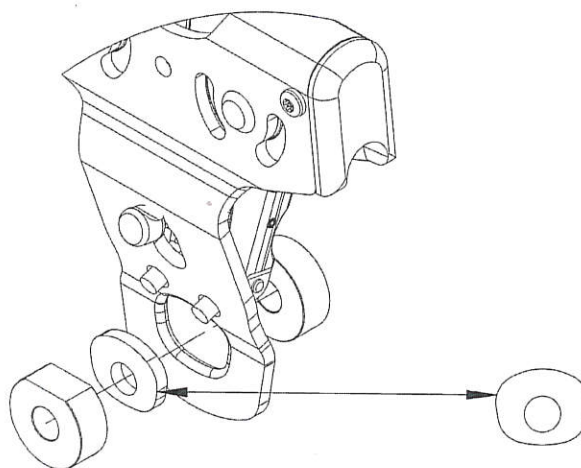
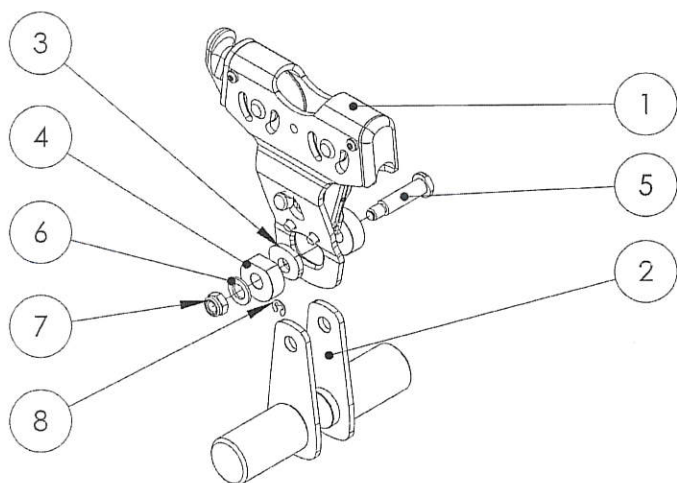

- 1 - Zippey trolley
- 2 - Grip-Link
- 3 - Spacer
- 4 - Washer x 2
- 5 - Axle
- 6 - M8 Washer
- 7 - Nyloc nut
- 8 - E-clip

Fig.1 -
Ensure Spacer (3) is in the correct orientation. Fit washer (4) on each side of the spacer.

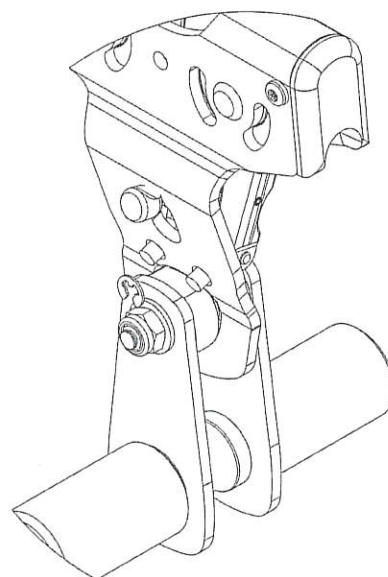
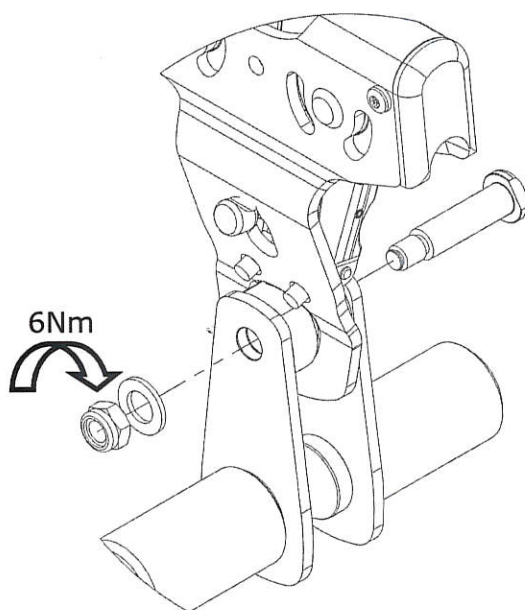
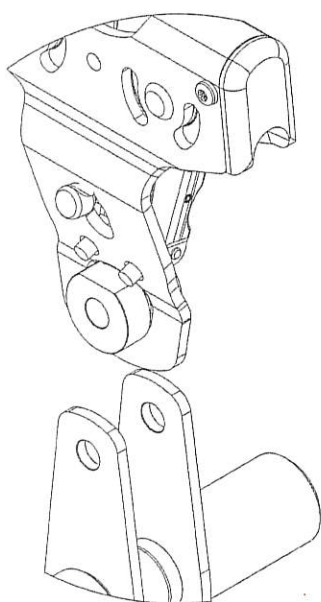

Fig.2 - Locate grip-link (2).

Fig.3 - Insert axle (5) from gate side through items (2,4,3,4,2). Fit washer (6) and nut (7). Tighten nut (7) to 6Nm.

Fig.4 - Fit E-clip (8). Ensure E-clip is not damaged or distorted. Correct fitment is important!