

# EASY EYELINER

This bright, lustrous, pure black eyeliner accentuates your beautiful eyelids.



The Comparison of EYELASHLABO with Other Companies' Products



**It provides a beautiful polished black patina for your eyes.**

Made out of natural materials, the carbon black retains its black beauty all day. Made with high lasting durable polymer. Neither sweat nor tears affect our eyeliner, so someone who has a problem with these can confidently use our product all day.

**The 0.1mm Easily Manipulable Tip:**

The soft-but-solid tip allows you to draw a beautiful line freely. The direct-liquid type maintains its condition and allows you to make full use of it.

**It is resistant to sweat, sebum, and tears but is easily removed with warm water.**

It can keep your line all day without affecting your extensions.

## The Recommendable Use of Easy Eyeliner

First, decide the line you want along the corner of your eye. Then begin drawing the line from the inner corner of your eye. The eyeliner refines your eyes beautifully.

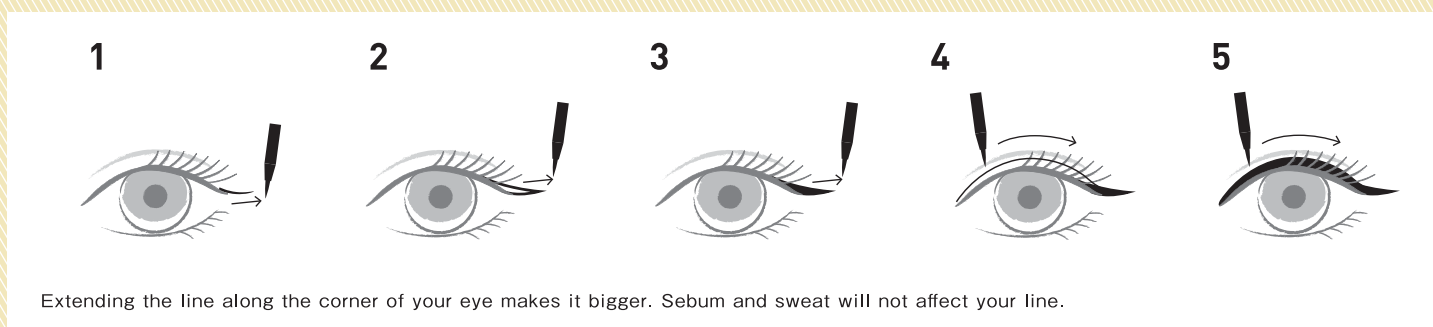

Extending the line along the corner of your eye makes it bigger. Sebum and sweat will not affect your line.